

vivalyte

LED makes the difference

NEONFLEX

VIVALYTE B.V.

Tel.: +32 56 42 65 35
Mail: info@vivalyte.com Web: www.vivalyte.com
Add.: Kouterstraat 6, Wevelgem, B-8560, Belgium VAT: BE500611159

vivalyte
NEON FLEX CATALOGUE

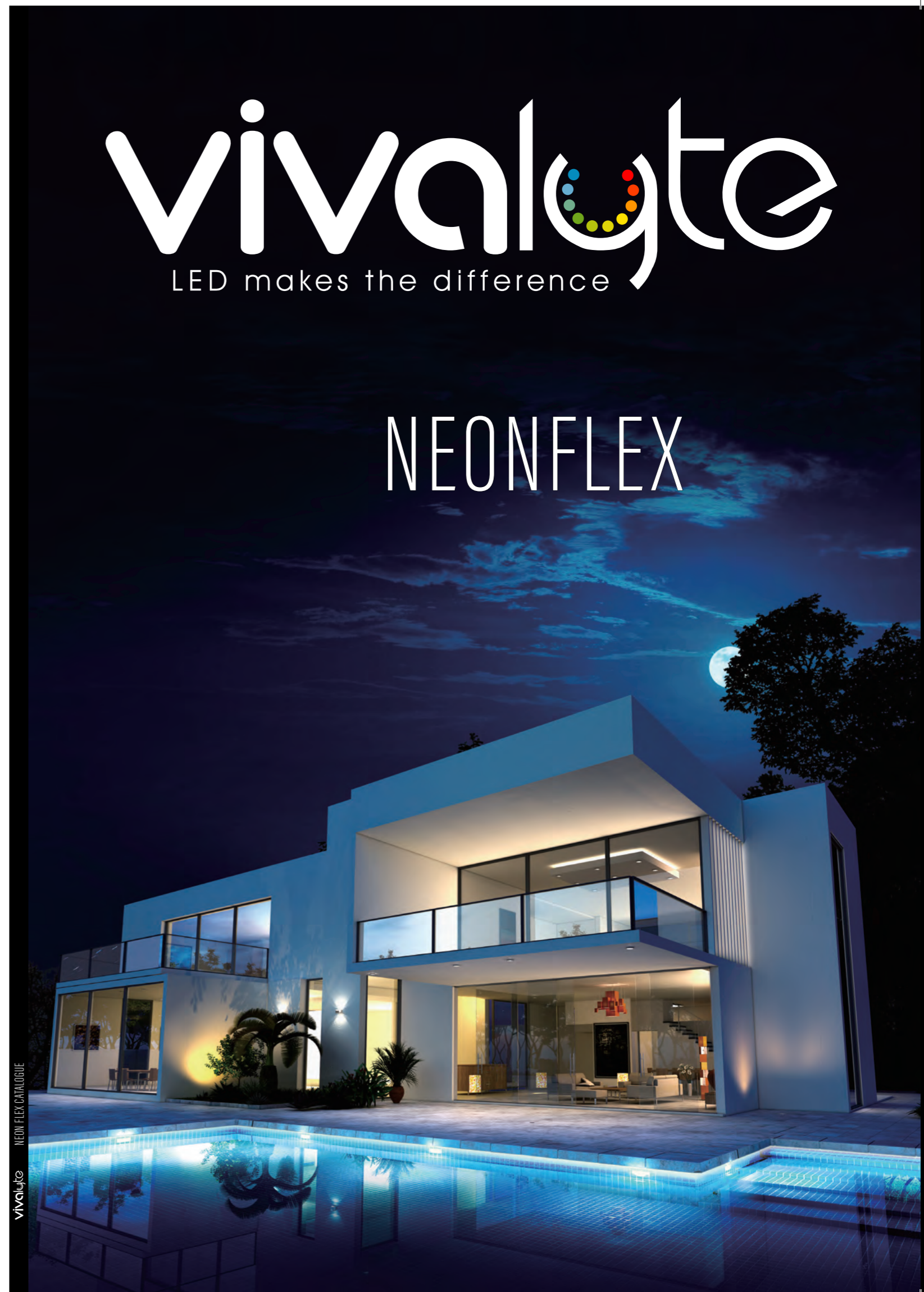



NEONFLEX

VIVALYTE B.V.

Tel.: +32 56 42 65 35

Mail: info@vivalyte.com Web: www.vivalyte.com

Add.: Kouterstraat 6, Wevelgem, B-8560, Belgium VAT: BE500611159

Rev.: September 2021

LED MAKES THE DIFFERENCE



QUICK GUIDE

Vertical Bending-D Series

Model No.	VNL-F16F	VNL-F16F-48V	VNL-F12F	VNL-F10F	VNL-F20C	VNL-F14C	VNL-F10C	VNL-F6C
Voltage (V DC)	24V	48V	24V	24V	24V	24V	24V	24V
Bending Diameter (mm)	120	120	60	30	120	60	25	20
Drawing								
Single color	✓	✓	✓	✓	✓	✓	✓	✓
WN	✓	✗	✓	✗	✓	✓	✗	✗
RGB	✓	✗	✓	✗	✓	✓	✗	✗
RGBW	✓	✗	✗	✗	✓	✗	✗	✗
Pixel (RGB)	✓	✗	✗	✗	✓	✗	✗	✗
PAGE	8-9	10-11	12-13	14-15	16-17	18-19	20-21	22-23

Horizontal Bending-S Series

Model No.	VNL-S10F	VNL-S6F	VNL-S4F	VNL-S10C	VNL-S6C	VNL-S5C	VNL-S10C-AC
Voltage (V DC)	24V	12V	24V	24V	12V	24V	AC 220V
Bending Diameter (mm)	60	30	25	60	30	30	60
Drawing							
Single color	✓	✓	✓	✓ (N2-4)	✓	✓	✓
WN	✓	✓	✗	✓	✓	✗	✗
RGB	✓	✗	✗	✓	✗	✗	✗
RGBW	✓	✗	✗	✓	✗	✗	✗
Pixel (RGB)	✗	✗	✗	✓	✗	✗	✗
PAGE	26-27	28-29	30-31	32-33	34-35	36-37	38-39

QUICK GUIDE

360° Lighting Neon

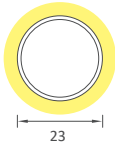
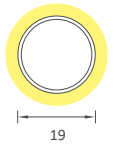
Model No.	VNL-R23C	VNL-R19C
Voltage (V DC)	24V	24V
Bending Diameter (mm)	120	120
Drawing		
Single color	✓	✓
WN	✗	✗
RGB	✓	✗
RGBW	✗	✗
Pixel	✗	✗
PAGE	42-43	44-45

3D Neon

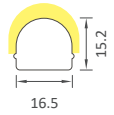
Model No.	VNL-FS16C
Voltage (V DC)	24V
Bending Diameter (mm)	60 (top) / 150 (side)
Drawing	
Single color	✓
WN	✗
RGB	✗
RGBW	✗
Pixel	✗
PAGE	48-49

CR Neon Series

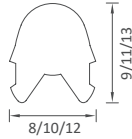
Model No.	VNL-SC8C/SC10C/SC12C
Voltage (V DC)	12V
Bending Diameter (mm)	--
Drawing	
Single color	✓
WN	✗
RGB	✗
RGBW	✗
Pixel	✗
PAGE	50-51

END CAP IP PROCESS

Glue Process (IP67)

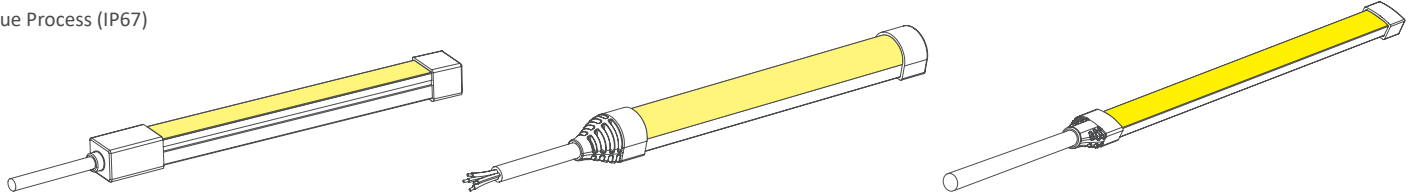

Molding pressed

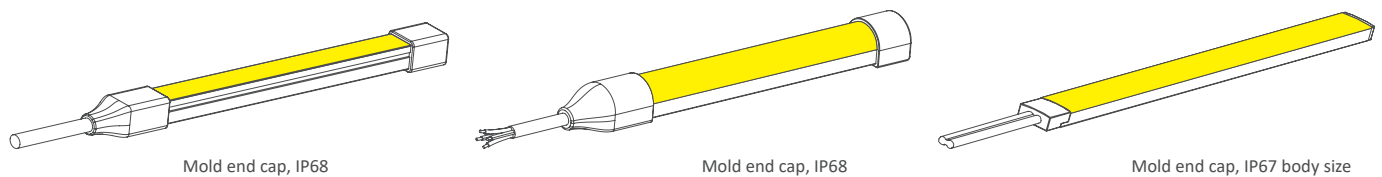

Mold end cap, IP68

Mold end cap, IP68

Mold end cap, IP67 body size

FRONT BENDING NEON FLEX







Features

- Color options: Single color, Tunable white and RGB.
- Design: Superior design with exquisite craftsmanship ensure stable and reliable performance.
- Flexibility: Top bending, min. bend diameter 120mm[4.72inch].
- IP grade: Molding pressed IP68 protection. Glue process end caps IP67 protection.
- Warranty: 5 years indoor, 3 years outdoor.
- Customization: multiple spec options, can be customized upon requirements.

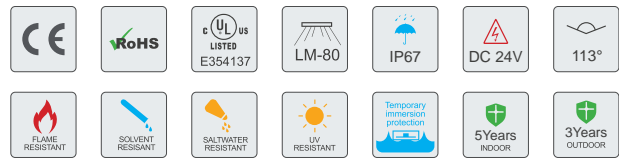

Photo-electric Parameters

Model No.	CRI	Voltage	Color	Lm/m	Lm/W	Measured Power (W/m)
VNL-F16F-HB30K	>80	24V DC	3000K	1122	64.1	17.28±10%
VNL-F16F-HB45K			4000K	1150	68.9	
VNL-F16F-HB70K			6500K	1140	65.5	
VNL-F16F-HB-R	>80	24V DC	Red	235	13.1	17.28±10%
VNL-F16F-HB-G			Green	687	38.2	
VNL-F16F-HB-B			Blue	148	8.2	
VNL-F16F-HB-Y			Yellow	202	11.2	
VNL-F16F-HB-O			Orange	211	11.7	
VNL-F16F-TW			6500K	467	65.3	
	2700K	488	67.6	7.2±10%		
	W+N	941	65.6	14.4±10%		
VNL-F16F-RGB	>80	24V DC	Red	89	17.6	5.76±10%
			Green	203	35.0	5.76±10%
			Blue	46	7.8	5.76±10%
			RGB	317	19.0	17.28±10%
VNL-F16F-Digital			24V DC	Red	48	7.2
	Green	110	15.8	4.32±10%		
	Blue	25	3.5	4.32±10%		
	RGB	178	12.6	12.96±10%		
VNL-F16F-RGBW	>80	24V DC	6500K	/	/	4.32±10%
			Red	61	12.2	4.32±10%
			Green	142	28.4	4.32±10%
			Blue	33	6.6	4.32±10%
			RGBW: 2300-6500K	476	25.0	17.28±10%

Basic Parameters

Model No.	LED QTY (pcs/m)	Product Size L*W*H (mm)	Min. Cuttable Length (mm)	Working Temperature	Storage Temperature
VNL-F16F-HB	112	10000*16*17	62.5	-20~+60°C	-20~+70°C
VNL-F16F-TW	240	10000*16*17	50.0		
VNL-F16F-RGB	72	5000*16*17	83.33		
VNL-F16F-Digital	60	10000*16*17	100.0		
VNL-F16F-RGBW	72	5000*16*17	83.33		

Profile Drawings

Glue Process (IP67)

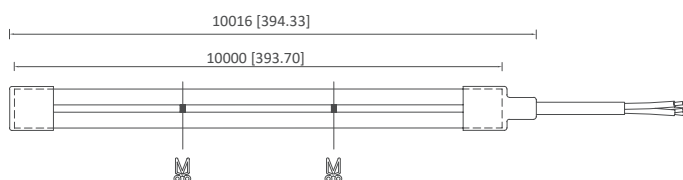

Molding pressed (IP68)

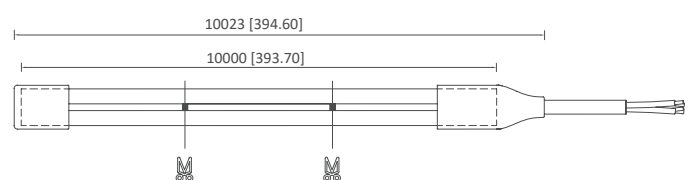

Sectional view

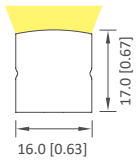

Bending Diameter

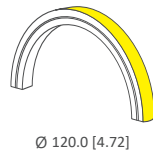

Top Bending

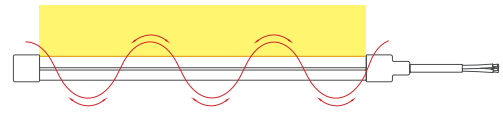

Front cap

Glue Process (IP67)

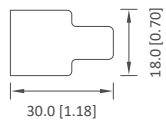

Molding pressed (IP68)

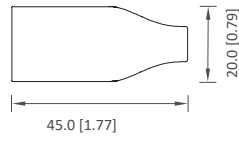

Closing End-cap

Glue Process (IP67)

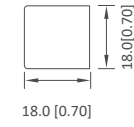

Molding pressed (IP68)

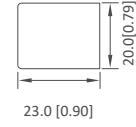

Remarks: "L" is the standard size of the light strip, can be customized according to the multiple of the minimum cutting unit length.

Luminous Intensity Distribution Diagram

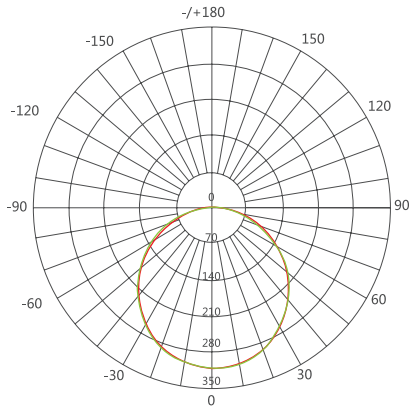

Unit: cd
 - C 0 /180,111.8°
 - C 90/270,112.8°
 AVERAGE BEAM ANGLE (50%): 112.3°

Note: the above two figures are tested with the sample VNL-F16F-TW.

Average Illumination

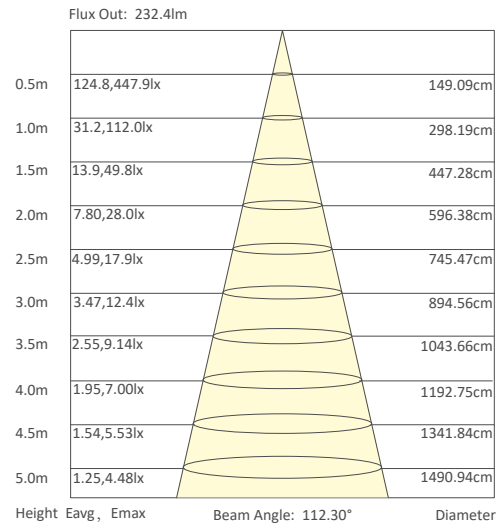

Product accessories

Free

Front cap
 VNL-F16F-PCS
 Quantity (m)/pcs: (5/10) 2/4
 Dimensions (L*W*H)mm: 30.0*18.0*18.0

Closing End-cap
 VNL-F16F-ECS
 Quantity (m)/pcs: (5/10) 2/4
 Dimensions (L*W*H)mm: 18.0*19.0*18.0

Optional

Front cap
 (Molding pressed)
 VNL-F16F-PCIM
 Quantity (m)/pcs: (5/10)
 Dimensions (L*W*H)mm: 45.0*19.2*20.2

Closing End-cap
 (Molding pressed)
 VNL-F16F-ECIM
 Quantity (m)/pcs: (5/10)
 Dimensions (L*W*H)mm: 23.0*19.2*20.2

Front cap(Side)
 VNL-F16F-PCB
 Quantity (m)/pcs: (5/10)
 Dimensions (L*W*H)mm: 25.0*30.0*19.0

3.5cm Aluminum track
 VNL-F16F-AP35
 Quantity (m)/pcs: (5/10)
 Dimensions (L*W*H)mm: 35.0*21.2*19.0

Aluminum Channel
 VNL-F16F-AP1000
 Quantity (m)/pcs: (5/10)
 Dimensions (L*W*H)mm: 1000*19.3*18.7

S-type Track
 VNL-F16F-SP500
 Quantity (m)/pcs: (5/10)
 Dimensions (L*W*H)mm: 500*17.2*17.8

Screws
 Quantity (m)/pcs: (5/10): 10/20
 Dimensions: 10mm

Silicone Glue
 VNL-SG45
 Quantity (m)/pcs: (5/10) 1
 300g/pc



Features

- Color options: Single color.
- Design: Superior design with exquisite craftsmanship ensure stable and reliable performance.
- Flexibility: Top bending, min. bend diameter 120mm[4.72inch].
- IP grade: Molding pressed IP68 protection. Glue process end caps IP67 protection.
- Warranty: 5 years indoor, 3 years outdoor.
- Customization: multiple spec options, can be customized upon requirements.

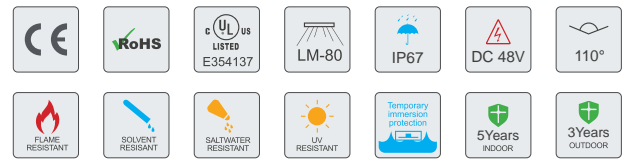

Photo-electric Parameters

Model No.	CRI	Voltage	Color	Lm/m	Lm/W	Measured Power (W/m)
VNL-F16F-48-26K	>80	48V DC	2600K	520	58	9.6±10%
VNL-F16F-48-30K			3000K	550	60	
VNL-F16F-48-42K			4200K	570	63	
VNL-F16F-48-50K			5000K	580	64	
VNL-F16F-48-60K			6000K	560	62	
NDF1617-48V-single color	>90	48V DC	2200K	500	56	9.6±10%
			2600K	520	58	
			2800K	540	59	
			4000K	570	63	
			4800K	590	66	
			5800K	560	62	
VNL-F16F-48-R	48V DC	Red	190	21	9.6±10%	
VNL-F16F-48-G		Green	540	61		
VNL-F16F-48-B		Blue	120	13		
VNL-F16F-48-Y		Yellow	150	17		
VNL-F16F-48-O		Orange	230	26		

Other Parameters

Model No.	LED QTY (pcs/m)	Product Size L*W*H (mm)	Min. Cuttable Length (mm)	Working Temperature	Storage Temperature
VNL-F16F-48	120	35000*16*17	100	-20~+60°C	-20~+70°C

Profile Drawings

Glue Process (IP67)

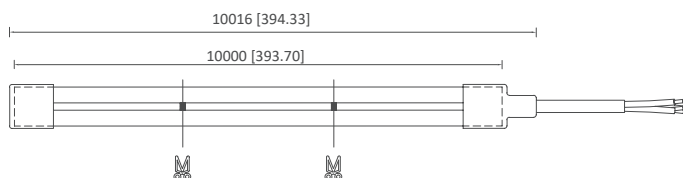

Molding pressed (IP68)

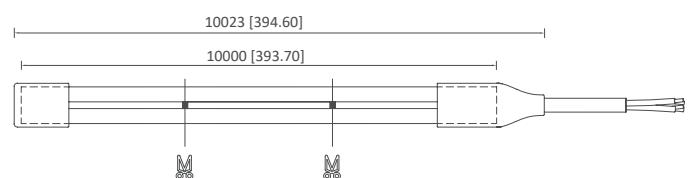

Sectional view

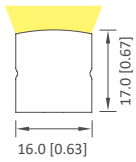

Bending Diameter

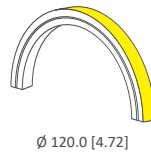

Top Bending

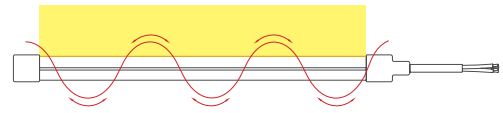

Front cap

Glue Process (IP67)

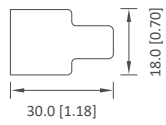

Molding pressed (IP68)

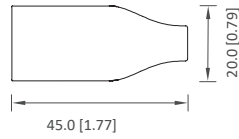

Closing End-cap

Glue Process (IP67)

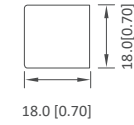

Molding pressed (IP68)

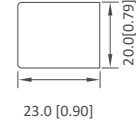

Remarks: "L" is the standard size of the light strip, can be customized according to the multiple of the minimum cutting unit length.

Luminous Intensity Distribution Diagram

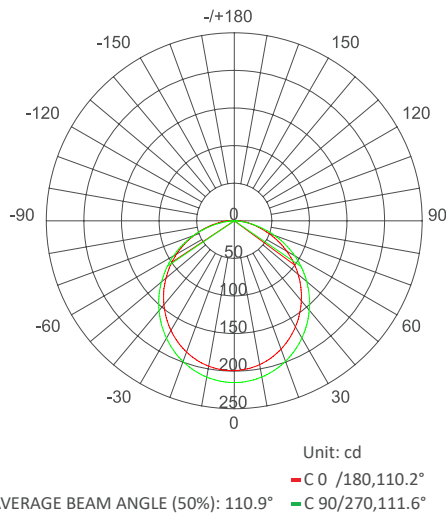

Note: the above two figures are tested with the sample VNL-F16F-48.

Average Illumination

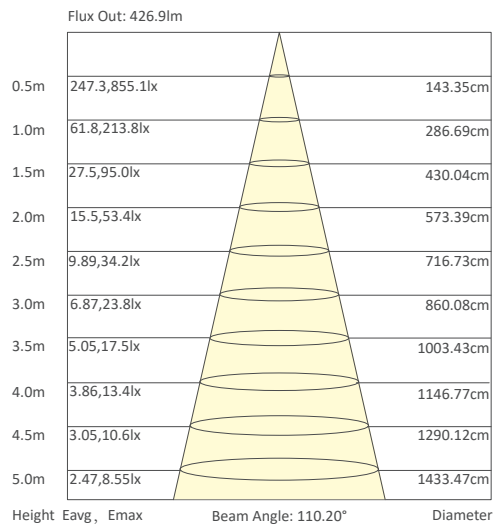

Product accessories

Free

 Front cap
VNL-F16F-48-PCS
Quantity (m)/pcs: (5/10) 2/4
Dimensions (L*W*H)mm: 30.0*18.0*18.0

 Closing End-cap
VNL-F16F-48-ECS
Quantity (m)/pcs: (5/10) 2/4
Dimensions (L*W*H)mm: 18.0*19.0*18.0

Optional

 Front cap
(Molding pressed)
VNL-F16F-48-PCIM
Quantity (m)/pcs: (5/10)
Dimensions (L*W*H)mm: 45.0*19.2*20.2

 Closing End-cap
(Molding pressed)
VNL-F16F-48-ECIM
Quantity (m)/pcs: (5/10)
Dimensions (L*W*H)mm: 23.0*19.2*20.2

 Front cap(Side)
VNL-F16F-48-PCB
Quantity (m)/pcs: (5/10)
Dimensions (L*W*H)mm: 25.0*30.0*19.0

 3.5cm Aluminum track
VNL-F16F-48-AP35
Quantity (m)/pcs: (5/10)
Dimensions (L*W*H)mm: 35.0*21.2*19.0

 Aluminum Channel
VNL-F16F-48-AP1000
Quantity (m)/pcs: (5/10)
Dimensions (L*W*H)mm: 1000*19.3*18.7

 S-type Track
VNL-F16F-48-SP500
Quantity (m)/pcs: (5/10)
Dimensions (L*W*H)mm: 500*17.2*17.8

 Screws
Quantity (m)/pcs: (5/10): 10/20
Dimensions: 10mm

 Silicone Glue
VNL-SG45
Quantity (m)/pcs: (5/10) 1
300g/pc



Features

- Color options: Single color, dimmable.
- Design: Superior design with exquisite craftsmanship ensure stable and reliable performance
- Flexibility: Top bending, min. bend diameter 60mm [2.36inch].
- IP grade: Molding pressed IP68 protection. Glue process end caps IP67 protection.
- Warranty: 5 years indoor, 3 years outdoor
- Customization: multiple spec options, can be customized upon requirements

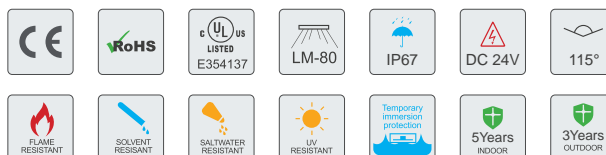

Photo-electric Parameters

Model No.	CRI	Voltage	Color	Lm/m	Lm/W	Measured Power (W/m)
VNL-F12F-23K	>90	24V DC	2300K	448	38.3	11.5±10%
VNL-F12F-27K	>80	24V DC	2700K	638	55.7	
VNL-F12F-30K			3000K	691	59.8	
VNL-F12F-41K			4100K	734	62.8	
VNL-F12F-48K			4800K	744	63.7	
VNL-F12F-60K			6000K	710	60.8	
VNL-F12F-R			Red	260	22.3	
VNL-F12F-G			Green	758	65.0	
VNL-F12F-B			Blue	154	13.2	
VNL-F12F-Y			Yellow	184	16.0	
VNL-F12F-O			Orange	304	26.1	
VNL-F12F-TW	>80	24V DC	3000K	463	64.3	7.2±10%
			6000K	464	64.9	7.1±10%
			W+N	912	63.7	14.3±10%
VNL-F12F-RGB		24V DC	Red	90	19.2	4.7±10%
			Green	234	47.7	4.9±10%
			Blue	48	10.2	4.6±10%
			RGB	356	25.3	14.1±10%

Basic Parameters

Model No.	LED QTY (pcs/m)	Product Size L*W*H (mm)	Min. Cuttable Length (mm)	Working Temperature	Storage Temperature
VNL-F12F	144	15000*12.5*12	41.66	-20~+60°C	-20~+70°C
VNL-F12F-TW	240	10000*12.5*12	50.0		
VNL-F12F-RGB	120	5000*12.5*12	50.0		

Profile Drawings

Glue Process (IP67)

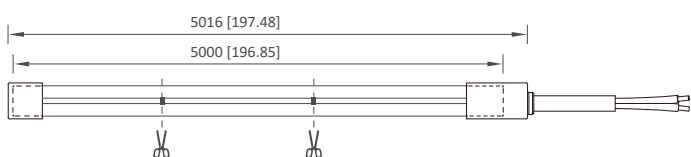

Molding pressed (IP68)

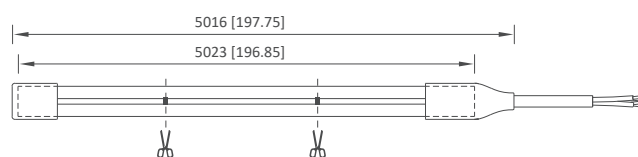

Unit:mm [inch]

Luminous Intensity Distribution Diagram

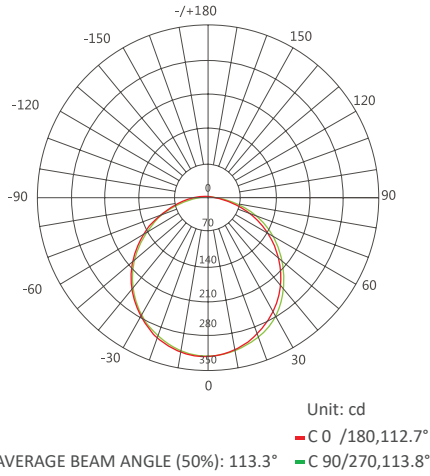

Note: the above two figures are tested with the sample VNL-F12F-TW at CCT 6000K.

Average Illumination

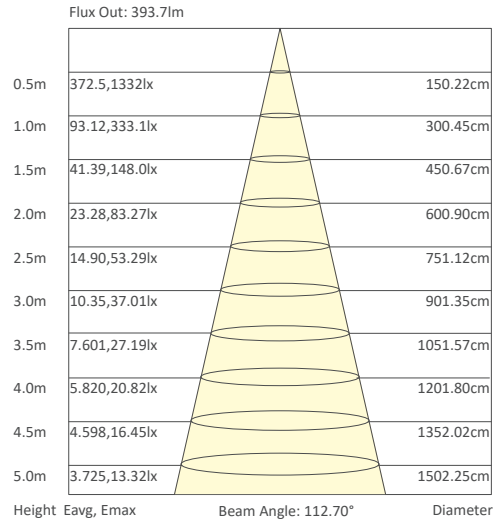

Sectional view

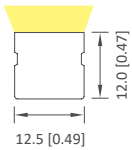

Bending Diameter

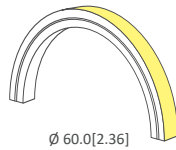

Top Bending

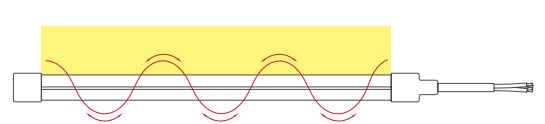

Front cap

Glue Process (IP67)

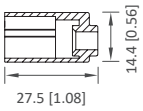

Molding pressed (IP68)

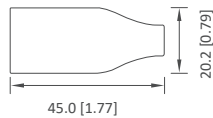

Closing End-cap

Glue Process (IP67)

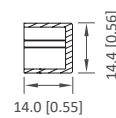

Molding pressed (IP68)

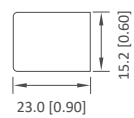

Product accessories

Free

Front cap
 VNL-F12F-PCS
 Quantity (m)/pcs: (5/10/15) 3/6/9
 Dimensions (L*W*H)mm: 27.5*14.9*14.4

Closing End-cap
 VNL-F12F-ECS
 Quantity (m)/pcs: (5/10/15) 3/6/9
 Dimensions (L*W*H)mm: 14*4.9*14.4

Optional

Front cap
 (Molding pressed)
 VNL-F12F-PCIIIM
 Quantity (m)/pcs: (5/10/15) 1
 Dimensions (L*W*H)mm: 44*15.7*15.2

Closing End-cap
 (Molding pressed)
 VNL-F12F-ECIM
 Quantity (m)/pcs: (5/10/15) 1
 Dimensions (L*W*H)mm: 23*15.7*15.2

Front cap (Left)
 VNL-F12F-PCL
 Quantity (m)/pcs: (5/10/15) 3/6/9
 Dimensions (L*W*H)mm: 27.5*20.9*14.4

Front cap (Right)
 VNL-F12F-PCR
 Quantity (m)/pcs: (5/10/15) 3/6/9
 Dimensions (L*W*H)mm: 27*20.4*14.4

Front cap (Bottom)
 VNL-F12F-PCB
 Quantity (m)/pcs: (5/10/15) 3/6/9
 Dimensions (L*W*H)mm: 27*20.4*14.9

Aluminum Channel
 VNL-F12F-AP1000
 Quantity (m)/pcs: (5/10/15) 5/10/15
 Dimensions (L*W*H)mm: 1000*14.8*15

S-type Track
 VNL-F12F-SP500
 Quantity (m)/pcs: (5/10/15) 5/10/15
 Dimensions (L*W*H)mm: 500*13.5*13.6

3.5cm Aluminum track
 VNL-F12F-AP35
 Quantity (m)/pcs: (5/10/15) 15/34/45
 Dimensions (L*W*H)mm: 35*14.8*15

Screws
 VNL-F12F-AP1000:3pcs/piece
 VNL-F12F-AP35:2pcs/piece
 VNL-F12F-MCA:2pcs/piece
 Dimensions: 10mm

Silicone Glue
 VNL-SG45
 Quantity (m)/pcs: (5/10) 1
 300g/pc

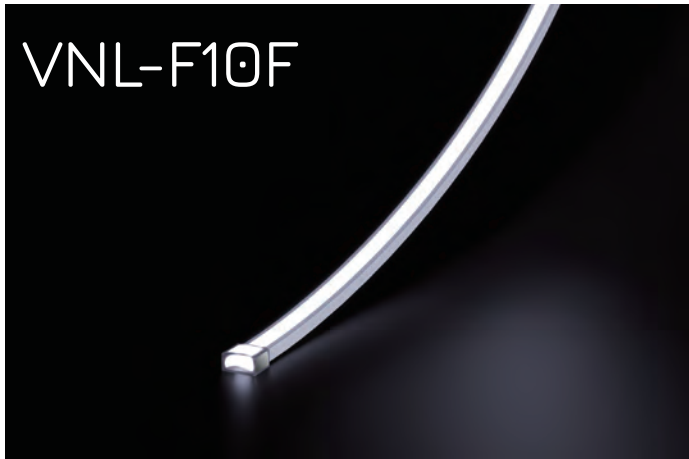

Features

- Color options: Single color, and R/G/B/Y/O.
- Design: Superior design with exquisite craftsmanship ensure stable and reliable performance.
- Flexibility: Top bending, min. bend diameter 30mm [1.18inch].
- IP grade: Molding pressed IP67 protection. Glue process end caps IP67 protection.
- Warranty: 5 years indoor, 3 years outdoor.
- Customization: multiple spec options, can be customized upon requirements.



Photo-electric Parameters

Model No.	CRI	Voltage	Color	Lm/m	Lm/W	Measured Power (W/m)
VNL-F10F-22K	>90	24V DC	2200K	360	50.0	7.2±10%
VNL-F10F-27K			2700K	432	60.0	
VNL-F10F-30K			3000K	446	62.0	
VNL-F10F-33K			3300K	468	65.0	
VNL-F10F-39K			3900K	446	62.0	
VNL-F10F-50K			5000K	504	70.0	
VNL-F10F-57K			5700K	525	73.0	
VNL-F10F-R			24V DC	Red	50	
VNL-F10F-G	Green	500		70.0		
VNL-F10F-B	Blue	100		14.0		
VNL-F10F-Y	Yellow	/		/		
VNL-F10F-O	Orange	/		/		

Basic Parameters

Model No.	LED QTY (pcs/m)	Product Size L*W*H (mm)	Min. Cuttable Length (mm)	Working Temperature	Storage Temperature
VNL-F10F	336	5000*10*4.8	20.83	-20~+60°C	-20~+70°C

Luminous Intensity Distribution Diagram

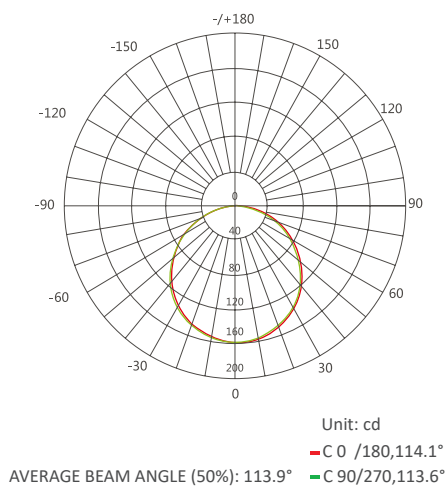

Average Illumination

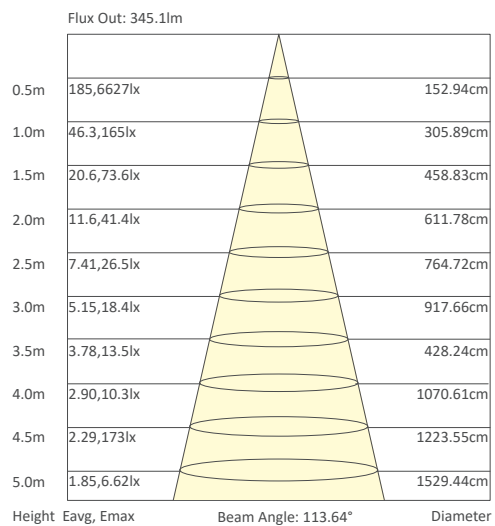

Profile Drawings

Unit:mm [inch]

Glue Process (IP67)

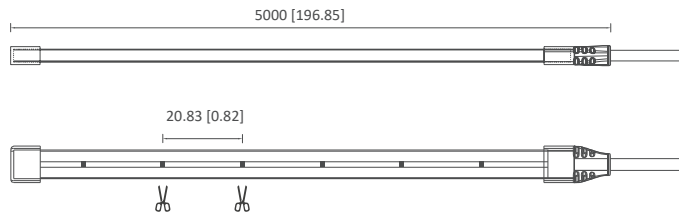

Molding pressed (IP67)

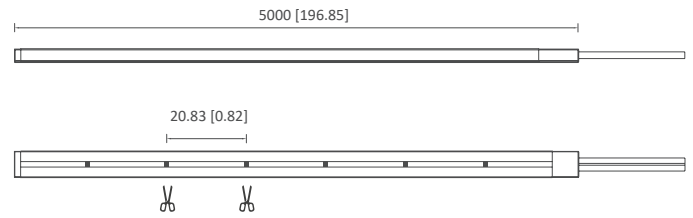

Sectional view

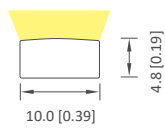

Bending Diameter

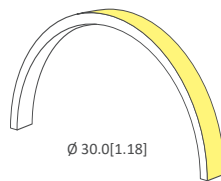

Top Bending

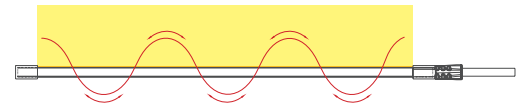

Front cap

Glue Process (IP67)

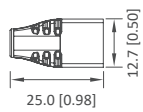

Molding pressed (IP67)

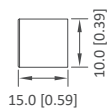

Closing End-cap

Glue Process (IP67)

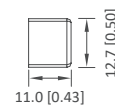

Molding pressed (IP67)

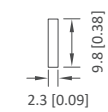

Remarks: "L" is the standard size of the light strip, can be customized according to the multiple of the minimum cutting unit length.

Product accessories

Free



Front cap
VNL-F10F-PCS

Quantity (m)/pcs: (5) 10
Dimensions (L*W*H)mm: 25.0*12.7*7.6



Closing End-cap
VNL-F10F-ECS

Quantity (m)/pcs: (5) 10
Dimensions (L*W*H)mm: 11.0*12.7*6.6

Optional



Front cap
(Molding pressed)
VNL-F10F-PCIIM

Quantity (m)/pcs: (5) 2
Dimensions (L*W*H)mm: 15.0*9.8*4.6



Closing End-cap
(Molding pressed)
VNL-F10F-ECIM

Quantity (m)/pcs: (15) 2
Dimensions (L*W*H)mm: 2.3*9.8*4.6



Aluminum Channel
VNL-F10F-AP20

Quantity (m)/pcs: (5) 15
Dimensions (L*W*H)mm: 20.0*12.4*7.0



Front connector set
VNL-F10F-ICJ

Quantity (m)/pcs: (15) 10
Dimensions (L*W*H)mm: 32.8*15.6*10.4



PC installation clip
VNL-F10F-MCP

Quantity (m)/pcs: (5) 15
Dimensions (L*W*H)mm: 25.0*12.0*10.



PC channel
VNL-F10F-PP1000

Quantity (m)/pcs: (5) 5
Dimensions (L*W*H)mm: 1000.0*12.0*9.0



Screws

Quantity (m)/pcs:
Dimensions: 10mm



Features

- Color options: Single color, RGB and pixel.
- Design: Superior design with exquisite craftsmanship ensure stable and reliable performance.
- Flexibility: Top bending, min. bend diameter 120mm [4.72inch].
- IP grade: Glue process end caps, IP67 protection.
- Warranty: 5 years indoor, 3 years outdoor.
- Customization: multiple spec options, can be customized upon requirements.



Photo-electric Parameters

Model No.	CRI	Voltage	Color	Lm/m	Lm/W	Measured Power (W/m)
VNL-F20C-27K	>80	24V DC	2700K	1374	80	15.36±10%
VNL-F20C-43K			4300K	1469	92	
VNL-F20C-53K			5300K	1459	87	
VNL-F20C-65K			6500K	1408	86	
VNL-F20C-RGB		24V DC	Red	141	31	5.12±10%
			Green	313	61	5.12±10%
			Blue	65	12	5.12±10%
			RGB	499	33	15.36±10%
VNL-F20C-Digital		24V DC	Red	112	14	5.18±10%
			Green	248	30	5.18±10%
			Blue	55	7	5.18±10%
			RGB	381	23	15.55±10%

Basic Parameters

Model No.	LED QTY (pcs/m)	Product Size L*W*H (mm)	Min. Cuttable Length (mm)	Working Temperature	Storage Temperature
VNL-F20C	96	5000*20*18	62.5	-20~+60°C	-20~+70°C
VNL-F20C-RGB	96	10000*20*18	62.5		
VNL-F20C-Digital	96	10000*20*18	83.33		

Luminous Intensity Distribution Diagram

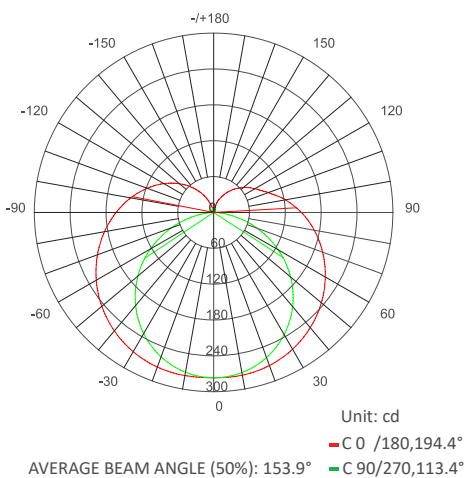

Average Illumination

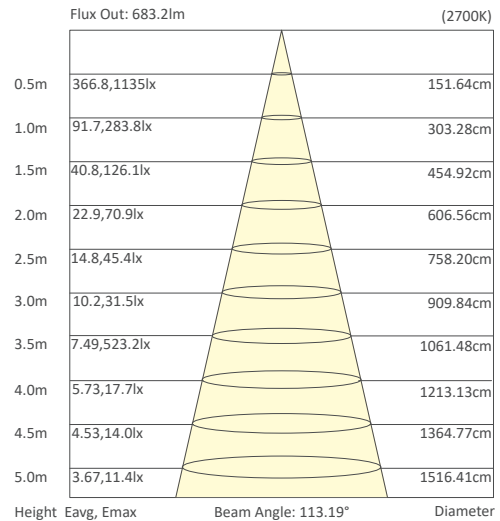

Note: the above two figures are tested with the sample VNL-F20C.

Profile Drawings

Unit:mm [inch]

Glue Process (IP67)

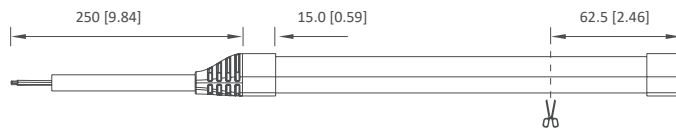

Sectional view

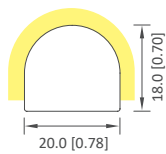

Bending Diameter

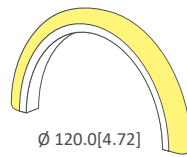

Top Bending

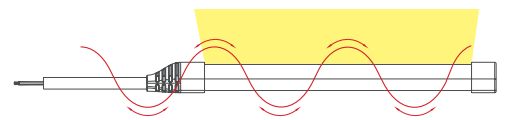

Front cap

Glue Process (IP67)

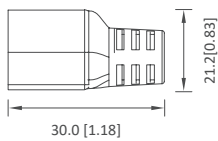

Closing End-cap

Glue Process (IP67)

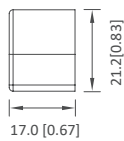

Remarks: "L" is the standard size of the light strip, can be customized according to the multiple of the minimum cutting unit length.

Product accessories

Free

	Front cap VNL-F20C-PCS	Quantity (m)/pcs: (5/10) 2/4 Dimensions (L*W*H)mm: 40.0*23.0*21.0
---	---------------------------	--

	Closing End-cap VNL-F20C-ECS	Quantity (m)/pcs: (5/10) 2/4 Dimensions (L*W*H)mm: 17.0*23.0*21.0
---	---------------------------------	--

Optional

	Front cap (Left) VNL-F20C-PCL	Quantity (m)/pcs: (5/10) 2/4 Dimensions (L*W*H)mm: 42.0*46.0*21.0
---	----------------------------------	--

	Front cap (Right) VNL-F20C-PCR	Quantity (m)/pcs: (5/10) 2/4 Dimensions (L*W*H)mm: 42.0*46.0*21.0
---	-----------------------------------	--

	Front cap (Bottom) VNL-F20C-PCB	Quantity (m)/pcs: (5/10) 2/4 Dimensions (L*W*H)mm: 31.50*22.89*44.50
---	------------------------------------	---

	Clip VNL-F20C-MCP	Quantity (m)/pcs: (5/10) 2/4 Dimensions (L*W*H)mm: 20*25*10
---	----------------------	--

	Plastic Channel VNL-F20C-PP1220	Quantity (m)/pcs: (5/10) 2/4 Dimensions (L*W*H)mm: 1220*25.5*10
---	------------------------------------	--

	Screws	Quantity (m)/pcs: VNL-F20C-MCP: 1pc/piece VNL-F20C-PP1220: 3pcs/piece Dimensions: 10mm
---	--------	---

	Silicone Glue VNL-SG45	Quantity (m)/pcs: (5/10) 1 300g/pc
---	---------------------------	---------------------------------------



Features

- Color options: Single color, dimmable.
- Design: Superior design with exquisite craftsmanship ensure stable and reliable performance
- Flexibility: Top bending, min. bend diameter 60mm [2.36inch]. Side bending, min. bend diameter 100mm [3.94inch]
- IP grade: Molding pressed IP68 protection. Glue process end caps IP67 protection.
- Warranty: 5 years indoor, 3 years outdoor
- Customization: multiple spec options, can be customized upon requirements

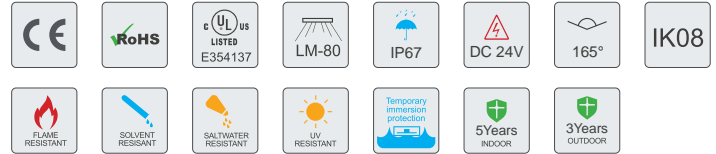

Photo-electric Parameters

Model No.	CRI	Voltage	Color	Lm/m	Lm/W	Measured Power (W/m)
VNL-F14C-26K	>80	24V DC	2600K	686	58.9	11.5±10%
VNL-F14C-29K			2900K	727	62.3	
VNL-F14C-40K			4000K	733	62.8	
VNL-F14C-47K			4700K	769	66.0	
VNL-F14C-57K			5700K	743	63.9	
VNL-F14C-R	>80	24V DC	Red	272	23.4	7.2±10%
VNL-F14C-G			Green	773	66.8	
VNL-F14C-B			Blue	158	13.6	
VNL-F14C-Y			Yellow	195	16.9	
VNL-F14C-O			Orange	334	28.8	
VNL-F14C-TW			24V DC	2600	511	
VNL-F14C-RGB	6200	577		80.3	7.2±10%	
	W+N	1095		76.0	14.4±10%	
VNL-F14C-RGB	24V DC	Red	104	22.1	4.7±10%	
		Green	324	64.9	5.0±10%	
		Blue	67	14.0	4.7±10%	
		RGB	492	34.5	14.4±10%	

Basic Parameters

Model No.	LED QTY (pcs/m)	Product Size L*W*H (mm)	Min. Cuttable Length (mm)	Working Temperature	Storage Temperature
VNL-F14C	144	15000*14*14	41.66	-20~+60°C	-20~+70°C
VNL-F14C-TW	240	10000*14*14	50		
VNL-F14C-RGB	120	5000*14*14	50		

Profile Drawings

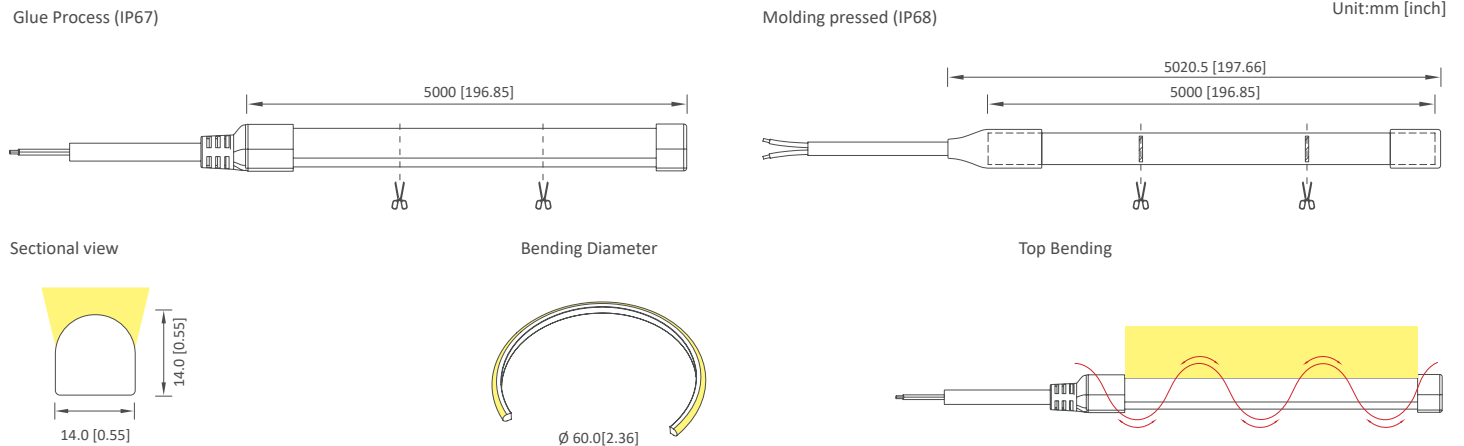

Front cap

Glue Process (IP67)

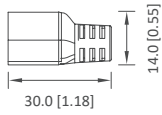

Molding pressed (IP68)

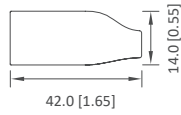

Closing End-cap

Glue Process (IP67)

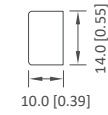

Molding pressed (IP68)

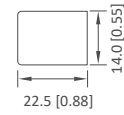

Remarks: "L" is the standard size of the light strip, can be customized according to the multiple of the minimum cutting unit length.

Luminous Intensity Distribution Diagram

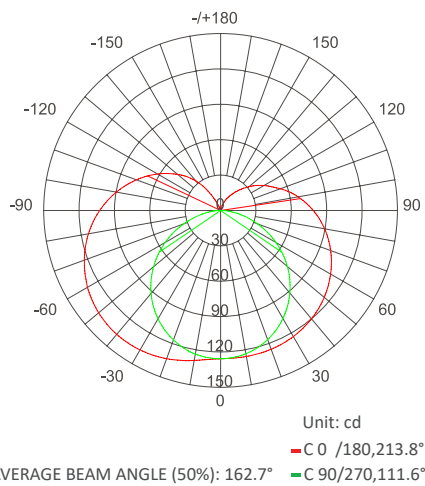

Note: the above two figures are tested with the sample VNL-F14C.

Average Illumination

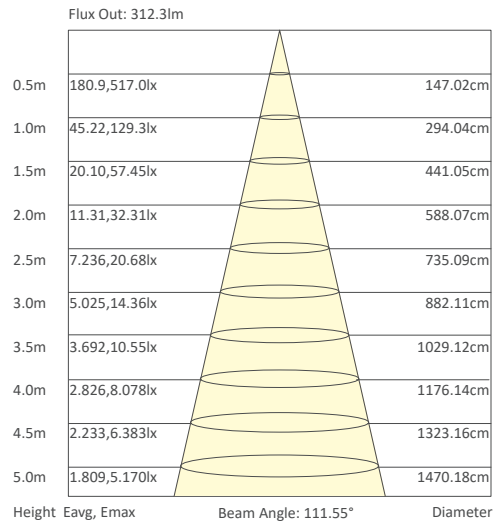

Product accessories

Free

 Front cap
VNL-F14C-PCS
Quantity (m)/pcs: (15) 2/4
Dimensions (L*W*H)mm: 31*16*15

 Closing End-cap
VNL-F14C-ECS
Quantity (m)/pcs: (15) 2/4
Dimensions (L*W*H)mm: 10*17*16

Optional

 Front cap
(Molding pressed)
VNL-F14C-PCIM
Quantity (m)/pcs: (15)
Dimensions (L*W*H)mm: 42*17*17

 Closing End-cap
(Molding pressed)
VNL-F14C-ECIM
Quantity (m)/pcs: (15)
Dimensions (L*W*H)mm: 23*17*17

 Plastic Clip
VNL-F14C-MCP
Quantity (m)/pcs: (15)
Dimensions (L*W*H)mm:

 Aluminum Channel
VNL-F14C-AP250
Quantity (m)/pcs: (15)
Dimensions (L*W*H)mm: 25*18*10

 Grip plate
VNL-F14C-GP
Quantity (m)/pcs: (15)
Dimensions (L*W*H)mm: 18*23*8

 Screws
Quantity (m)/pcs:
Dimensions: 10mm

 Silicone Glue
VNL-SG45
Quantity (m)/pcs: (15) 1
300g/pc



Features

- Color options: Single color and tunable white.
- Design: Superior design with exquisite craftsmanship ensure stable and reliable performance.
- Flexibility: Side bending, min. bend diameter 25mm [0.98inch].
- IP grade: Silicone extrusion, Glue process end caps IP54 protection.
- Warranty: 5 years indoor, 3 years outdoor.
- Customization: multiple spec options, can be customized upon requirements

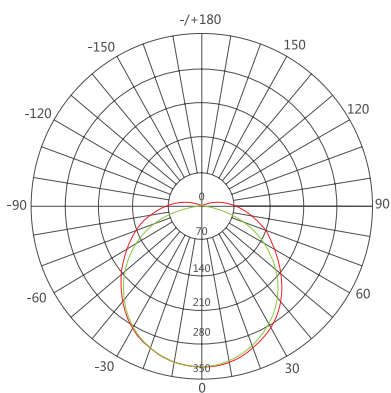

Photo-electric Parameters

Model No.	CRI	Voltage	Color	Lm/m	Lm/W	Measured Power (W/m)
VNL-F10C-22K	>90	24V DC	2200K	1060	55.4	19.2±10%
VNL-F10C-27K			2700K	1060	61.0	
VNL-F10C-29K			2900K	1128	62.9	
VNL-F10C-40K			4000K	1147	62.6	
VNL-F10C-50K			5000K	1241	67.8	
VNL-F10C-60K			6000K	1239	67.1	

Model No.	LED QTY (pcs/m)	Product Size L*W*H (mm)	Min. Cuttable Length (mm)	Working Temperature	Storage Temperature
VNL-F10C	420	5000*10*4	16.66	-20~+60°C	-20~+70°C

Luminous Intensity Distribution Diagram



Unit: cd
 - C 0 /180,125.9°
 - C 90/270,114.8°
 AVERAGE BEAM ANGLE (50%): 120.3°

Average Illumination

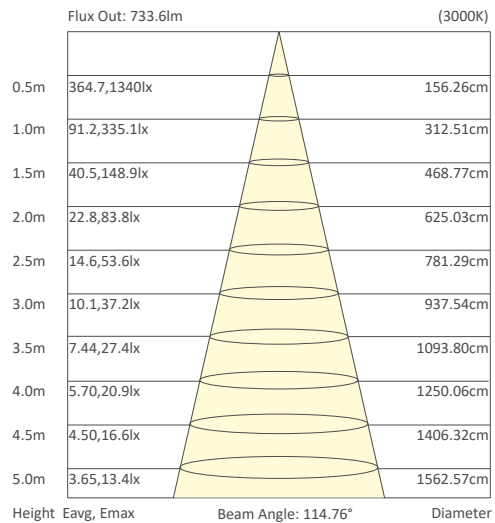

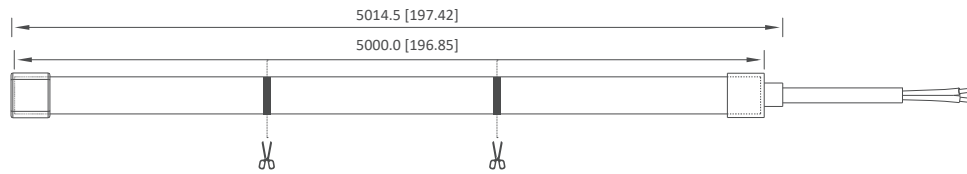

Front cap

Closing End-cap

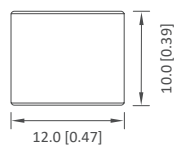
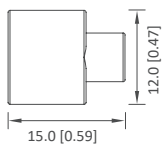

Remarks: "L" is the standard size of the light strip, can be customized according to the multiple of the minimum cutting unit length.

Sectional view

Bending Diameter

Top Bending

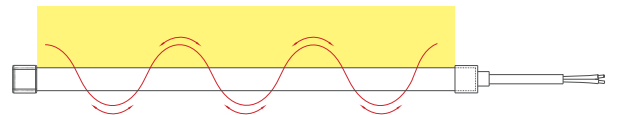
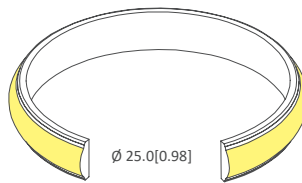
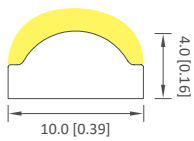

Product accessories

Free



Front cap
VNL-F10C-PCS

Quantity (m)/pcs: (5) 2-4
Dimensions (L*W*H)mm: 15*12*6



Closing End-cap
VNL-F10C-ECS

Quantity (m)/pcs: (5) 2-4
Dimensions (L*W*H)mm: 10*12*6

Optional



Aluminum Channel
VNL-F10C-AP1000

Quantity (m)/pcs: (5)
Dimensions (L*W*H)mm: 1000*14*4



Wire-to-Board Connector
VNL-F10C-QJ-DJ-N10XB-2

Quantity (m)/pcs: (5)
Dimensions (L*W*H)mm: 24.3*14.6*7.7



Board-to-board connector
VNL-F10C-QJ-DJ-N10BB-2

Quantity (m)/pcs: (5)
Dimensions (L*W*H)mm: 19.55*14.6*7.7



Screws

Quantity (m)/pcs:
Dimensions: 10mm



Silicone Glue
VNL-SG45

Quantity (m)/pcs: (5) 1
300g/pc

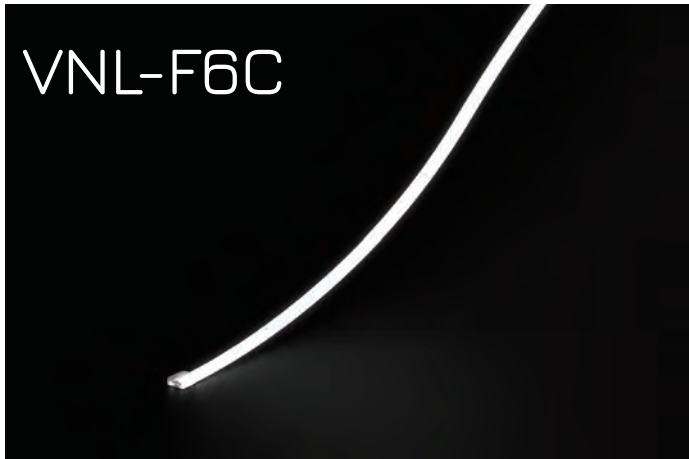

Features

- Color options: Single color and tunable white.
- Design: Superior design with exquisite craftsmanship ensure stable and reliable performance.
- Flexibility: Side bending, min. bend diameter 20mm [0.79inch].
- IP grade: Silicone extrusion, Glue process end caps, IP54 protection.
- Warranty: 5 years indoor, 3 years outdoor.
- Customization: multiple spec options, can be customized upon requirements



Photo-electric Parameters

Model No.	CRI	Voltage	Color	Lm/m	Lm/W	Measured Power (W/m)
VNL-F6C-23K	>90	24V DC	2300K	516	64.5	7.2±10%
VNL-F6C-25K			2500K	539	71.1	
VNL-F6C-27K			2700K	558	76.0	
VNL-F6C-30K			3000K	547	72.9	
VNL-F6C-35K			3500K	621	81.6	
VNL-F6C-40K			4000K	552	73.2	
VNL-F6C-51K			5100K	618	81.6	
VNL-F6C-62K			6200K	609	79.5	

Basic Parameters

Model No.	LED QTY (pcs/m)	Product Size L*W*H (mm)	Min. Cuttable Length (mm)	Working Temperature	Storage Temperature
VNL-F6C	336	5000*6*3	20.83	-20~+60℃	-20~+70℃

Luminous Intensity Distribution Diagram

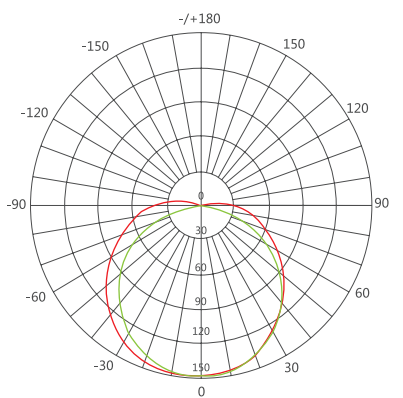

Unit: cd
 - C 0 /180,131.7°
 - C 90/270,114.6°
 AVERAGE BEAM ANGLE (50%): 123.1°

Average Illumination

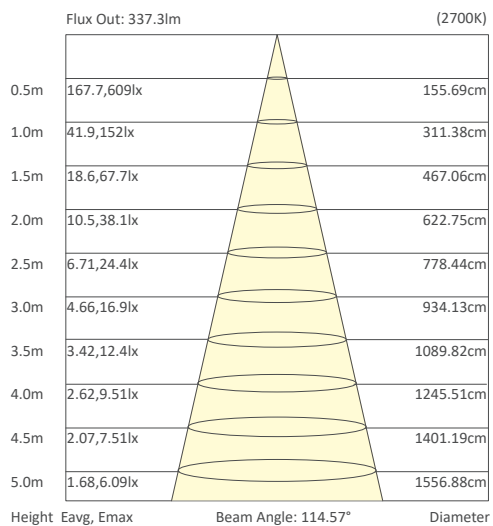

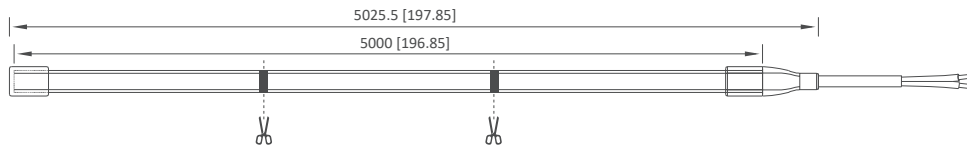

Front cap

Closing End-cap

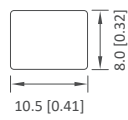
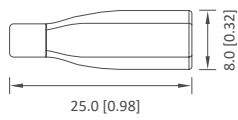

Remarks: "L" is the standard size of the light strip, can be customized according to the multiple of the minimum cutting unit length.

Sectional view

Bending Diameter

Top Bending

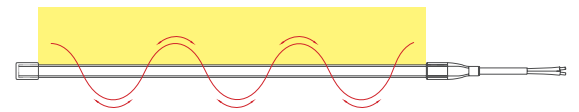
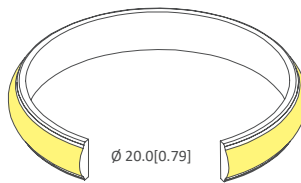
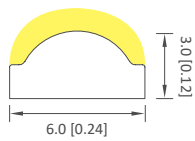

Product accessories

Free

	Front cap VNL-F6C-PCS	Quantity (m)/pcs: (5) 2-4 Dimensions (L*W*H)mm: 25*8*6
---	--------------------------	---

	Closing End-cap VNL-F6C-ECS	Quantity (m)/pcs: (5) 2-4 Dimensions (L*W*H)mm: 11*8*5
---	--------------------------------	---

Optional

	Aluminum Channel VNL-F6C-AP1000	Quantity (m)/pcs: (5) XX Dimensions (L*W*H)mm: 200*10*4
---	------------------------------------	--

	Seamless connector VNL-F6C-TSC-06-2	Quantity (m)/pcs: (5) Dimensions (L*W*H)mm: 16.25*8.2*4
---	--	--

	connection wire VNL-F6C-QG-TSC-06-XT	Quantity (m)/pcs: (5) XX Dimensions : 20AWG L=150/5mm
---	---	--

	Screws	Quantity (m)/pcs: Dimensions: 10mm
---	--------	---------------------------------------

	Silicone Glue VNL-SG45	Quantity (m)/pcs: (5) 1 300g/pc
---	---------------------------	------------------------------------

SIDE BENDING NEON FLEX



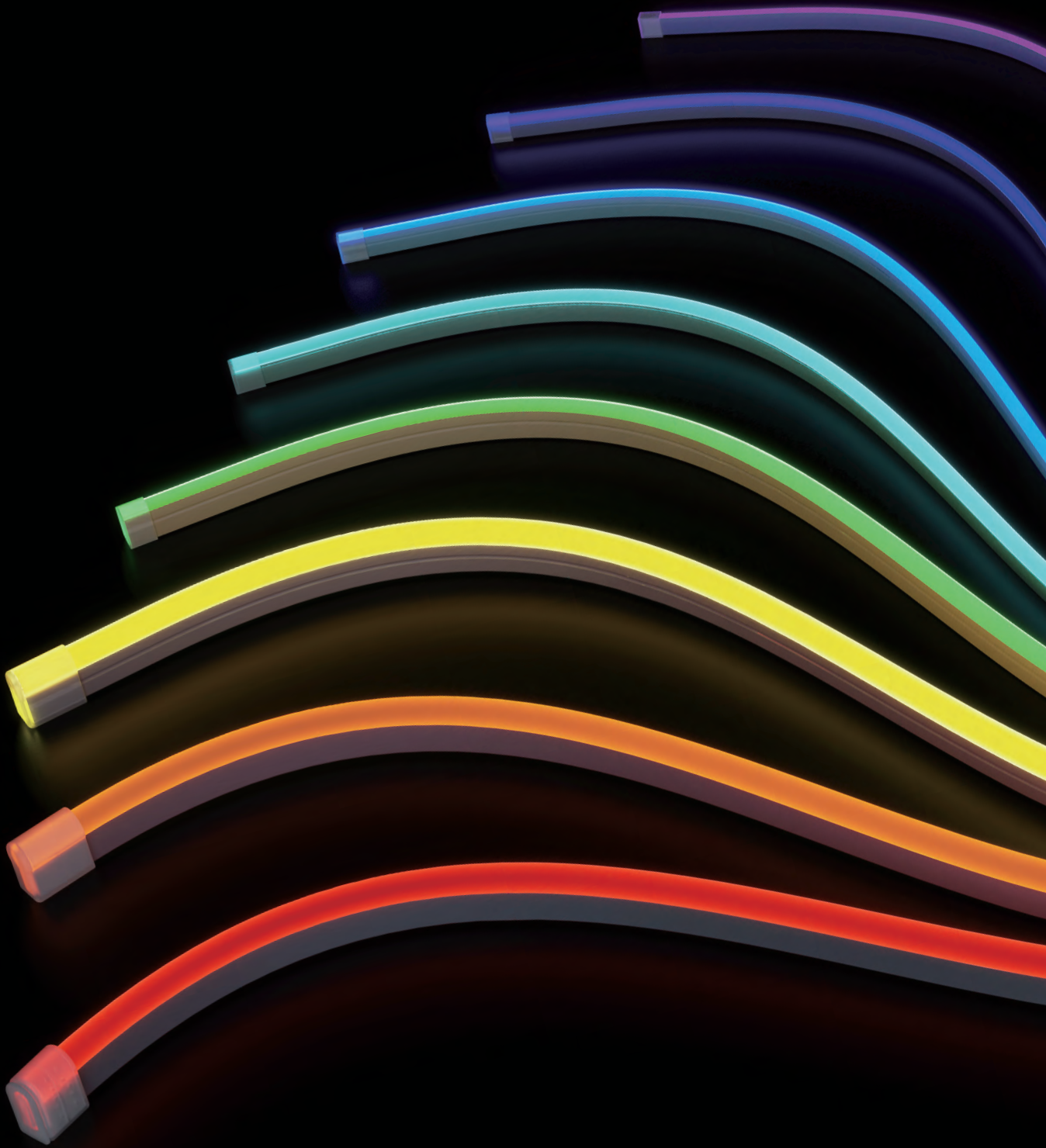



Features

- Color options: Single color, tunable white, RGB and RGBW
- Design: Superior design with exquisite craftsmanship ensure stable and reliable performance.
- Flexibility: Side bending, min. bend diameter 60mm [1.18inch].
- IP grade: Silicone extrusion, molding pressed IP68 protection. Glue process end caps IP67 protection.
- Warranty: 5 years indoor, 3 years outdoor.
- Customization: multiple spec options, can be customized upon requirements



Photo-electric Parameters

Model No.	CRI	Voltage	Beam Angle	Color	Lm/m	Lm/W	Measured Power (W/m)
VNL-S10F-23K	>90	24V DC	120°	2300K	326	27.4	11.8±10%
VNL-S10F-30K	>80	24V DC	120°	3000K	379	32.4	11.7±10%
VNL-S10F-40K				4000K	402	34.5	11.6±10%
VNL-S10F-50K				5000K	399	34.0	11.7±10%
VNL-S10F-63K				6300K	392	33.4	11.7±10%
VNL-S10F-R	/	24V DC	120°	Red	146	12.2	12.0±10%
VNL-S10F-G				Green	293	24.1	
VNL-S10F-B				Blue	61	14.9	
VNL-S10F-Y				Yellow	291	24.0	
VNL-S10F-O				Orange	122	10.8	
VNL-S10F-TW	>80	24V DC	115°	2700K	263	36.6	7.2±10%
				6500K	276	38.5	7.2±10%
				W+N	528	36.8	14.4±10%
VNL-S10F-RGB	/	24V DC	120°	Red	146	12.2	4.5±10%
				Green	293	24.1	5.6±10%
				Blue	61	14.9	6.3±10%
				RGB	291	24.0	16.4±10%
VNL-S10F-RGBW	>90	24V DC	120°	3000K	172	29.2	5.04±10%
	/	24V DC	120°	Red	42	9.4	5.04±10%
				Green	150	28.2	5.04±10%
				Blue	34	6.5	5.04±10%
				RGBW	394	19.2	20.16 ±10%

Basic Parameters

Model No.	LED QTY (pcs/m)	Product Size L*W*H (mm)	Min. Cuttable Length (mm)	Working Temperature	Storage Temperature
VNL-S10F	112	15000*10*17	62.5	-20~+60°C	-20~+70°C
VNL-S10F-TW	240	10000*10*17	50.0		
VNL-S10F-RGB	108	5000*10*17	55.6		
VNL-S10F-RGBW	84	5000*10*17	71.42		

Profile Drawings

Glue Process (IP67)

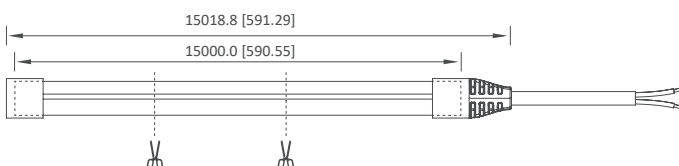

Molding Press Moulded (IP68)

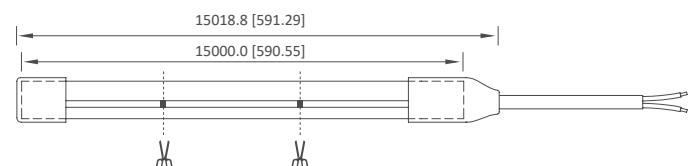

Sectional view

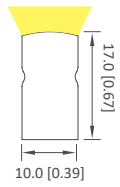

Bending Diameter

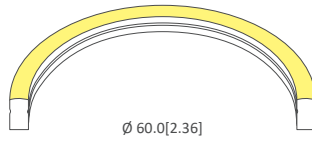

Top Bending

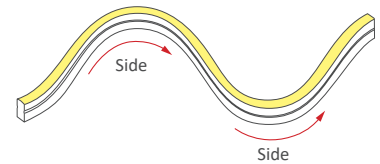

Front cap

Glue Process (IP67)

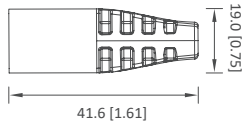

Molding pressed (IP68)

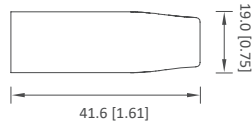

Closing End-cap

Glue Process (IP67)

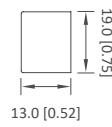

Molding pressed (IP68)

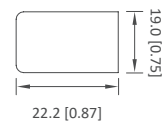

Remarks: "L" is the standard size of the light strip, can be customized according to the multiple of the minimum cutting unit length.

Luminous Intensity Distribution Diagram

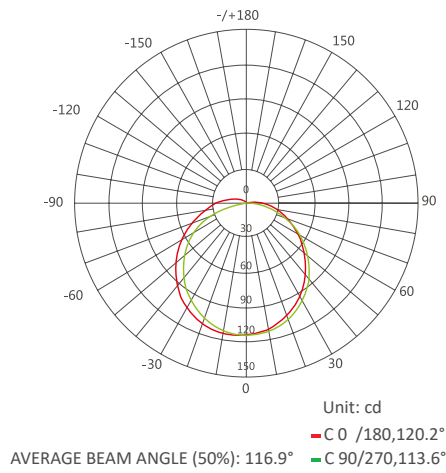

Note: the above two figures are tested with the sample VNL-S10F.

Average Illumination

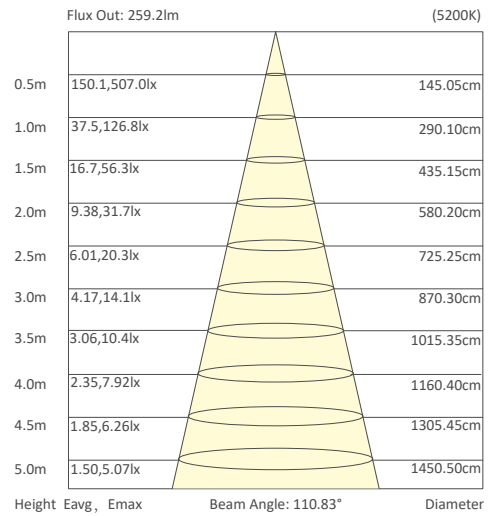

Product accessories

Free

Front cap (Glue Process) VNL-S10F-PCS
Quantity (m)/pcs: (10/15) 2-4pcs
Dimensions (L*W*H)mm: 41*12*19

Closing End-cap (Glue Process) VNL-S10F-ECS
Quantity (m)/pcs: (10/15) 2-4pcs
Dimensions (L*W*H)mm: 13*14*8

Optional

Front cap (Molding pressed) VNL-S10F-PCIIM
Quantity (m)/pcs: (10/15)
Dimensions (L*W*H)mm: 44*28*15

Closing End-cap (Molding pressed) VNL-S10F-ECIM
Quantity (m)/pcs: (10/15)
Dimensions (L*W*H)mm: 28*28*15

Front cap (Left) VNL-S10F-PCL
Quantity (m)/pcs: (10/15)
Dimensions (L*W*H)mm: 26*18*19

Front cap (Right) VNL-S10F-PCR
Quantity (m)/pcs: (10/15)
Dimensions (L*W*H)mm: 26*18*19

Front cap (bottom) VNL-S10F-PCB
Quantity (m)/pcs: (10/15)
Dimensions (L*W*H)mm: 26*12*24

Aluminum track VNL-S10F-AP35
Quantity (m)/pcs: (10/15)
Dimensions (L*W*H)mm: 25*12.3*17

S-type track VNL-S10F-SP500
Quantity (m)/pcs: (10/15)
Dimensions (L*W*H)mm: 500*11*17

Aluminum channel VNL-S10F-AP150
Quantity (m)/pcs: (10/15)
Dimensions (L*W*H)mm: 1000*12.3*17

Screws
Quantity (m)/pcs:
Dimensions: 10mm

Silicone Glue VNL-SG45
Quantity (m)/pcs: (10/15) 1
300g/pc



Features

- Color options: Single color and tunable white.
- Design: Superior design with exquisite craftsmanship ensure stable and reliable performance.
- Flexibility: Side bending, min. bend diameter 30mm [1.18inch].
- IP grade: Silicone extrusion, Glue process end caps IP67 protection.
- Warranty: 5 years indoor, 3 years outdoor.
- Customization: multiple spec options, can be customized upon requirements



Photo-electric Parmamters

Model No.	CRI	Voltage	Color	Lm/m	Lm/W	Rated Power (W/m)	
VNL-S6F-22K	>90	12V DC	2200K	123	10.7	12.0	
VNL-S6F-27K	>80	12V DC	2700K	178	16.2		
VNL-S6F-29K			2900K	214	18.8		
VNL-S6F-39K			3900K	218	19.3		
VNL-S6F-45K			4500K	211	18.8		
VNL-S6F-47K			4700K	198	18.7		
VNL-S6F-54K			5400K	224	19.9		
VNL-S6F-58K			5800K	234	21.1		
VNL-S6F-R	/	12V DC	Red	86	7.2		12.0
VNL-S6F-G			Green	114	9.5		
VNL-S6F-B			Blue	39	3.3		
VNL-S6F-Y			Yellow	201	16.8		
VNL-S6F-TW	>80	12V DC	2900K	206	31	14.4	
			5200K	220	33		

Basic Parameters

Model No.	LED QTY (pcs/m)	Product Size L*W*H (mm)	Min. Cuttable Length (mm)	Working Temperature	Storage Temperature
VNL-S6F	120	5000*6*12	25	-20~+60°C	-20~+70°C
VNL-S6F-TW	240				

Profile Drawings

Unit:mm [inch]

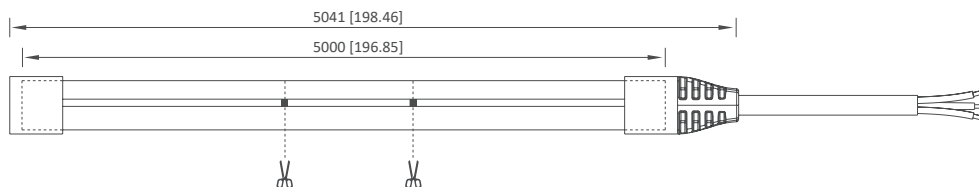

Front cap

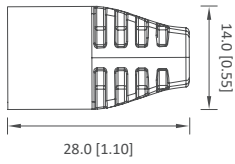

Closing End-cap

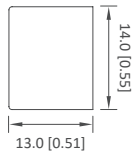

Remarks: "L" is the standard size of the light strip, can be customized according to the multiple of the minimum cutting unit length.

Sectional view

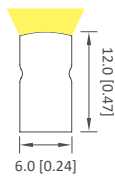

Bending Diameter

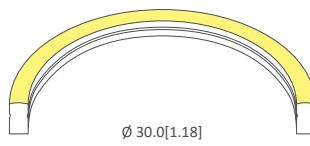

Top Bending

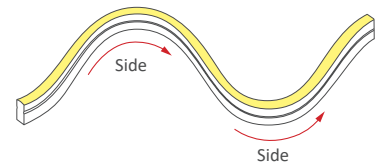

Luminous Intensity Distribution Diagram

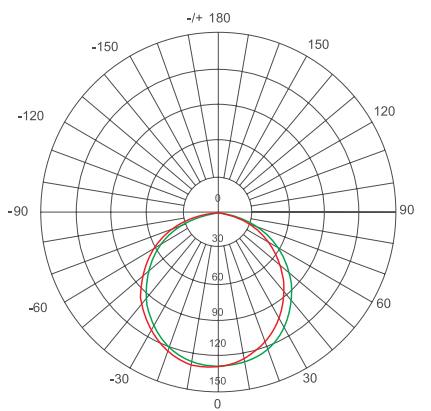

Unit: cd
 - C 0 /180,111.1°
 - C 90/270,113.5°
 AVERAGE BEAM ANGLE (50%): 112.3°

Note: the above two figures are tested with the sample 5200K .

Average Illumination

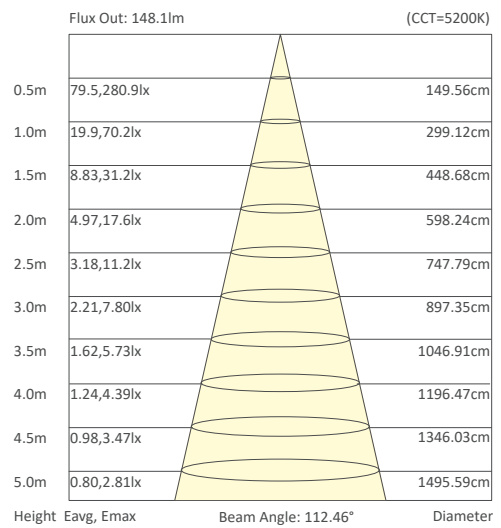

Product accessories

Free

 Front cap
 VNL-S6F-PCS
 Quantity (m)/pcs: (5) 3
 Dimensions (L*W*H)mm: 28*14*9.23

 Closing End-cap
 VNL-S6F-ECS
 Quantity (m)/pcs: (5) 3
 Dimensions (L*W*H)mm: 13*14*8

Optional

 Plastic Clip
 VNL-S6F-MCP
 Quantity (m)/pcs: (5) 12
 Dimensions (L*W*H)mm: 12*10*12

 Aluminum channel
 VNL-S6F-AP1000
 Quantity (m)/pcs:
 Dimensions (L*W*H)mm: 1000*6.62*13.5

 Screws
 Quantity (m)/pcs:
 Dimensions: 10mm

 Silicone Glue
 VNL-SG45
 Quantity (m)/pcs: (5) 1
 300g/pc



Features

- Color options: Single color.
- Design: Superior design with exquisite craftsmanship ensure stable and reliable performance.
- Flexibility: Side bending, min. bend diameter 25mm [0.98inch].
- IP grade: Silicone extrusion. Glue process end caps, IP67 protection.
- Warranty: 5 years indoor, 3 years outdoor.
- Customization: multiple spec options, can be customized upon requirements



Photo-electric Parameters

Model No.	CRI	Voltage	Color	Lm/m	Lm/W	Measured Power (W/m)
VNL-S4F-21K	>70	24V DC	2100K	153	16.2	9.6±10%
VNL-S4F-27K			2700K	296	31.0	
VNL-S4F-40K			4000K	324	33.9	
VNL-S4F-45K			4500K	332	34.4	
VNL-S4F-50K			5000K	329	34.4	
VNL-S4F-R		24V DC	Red	79	8.6	9.6±10%
VNL-S4F-G			Green	312	20.7	
VNL-S4F-B			Blue	43	4.6	

Basic Parameters

Model No.	LED QTY (pcs/m)	Product Size L*W*H (mm)	Min. Cuttable Length (mm)	Working Temperature	Storage Temperature
VNL-S4F	120	5000*4*10	50	-20~+60°C	-20~+70°C

Luminous Intensity Distribution Diagram

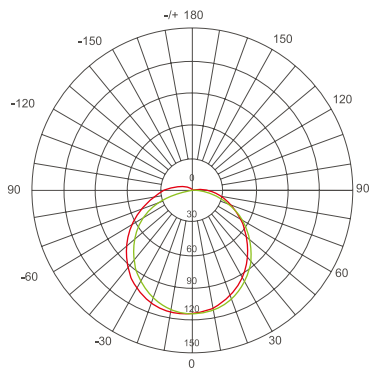

Unit: cd
 - C 0 /180,120.2°
 - C 90/270,114.2°

AVERAGE BEAM ANGLE (50%): 117.2°

Average Illumination

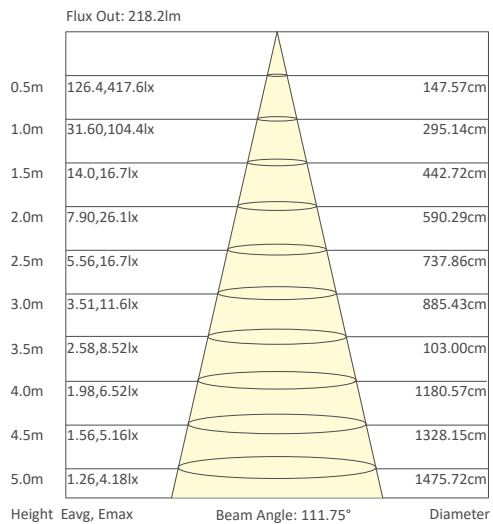

Note: the above two figures are tested with the sample 2700K .

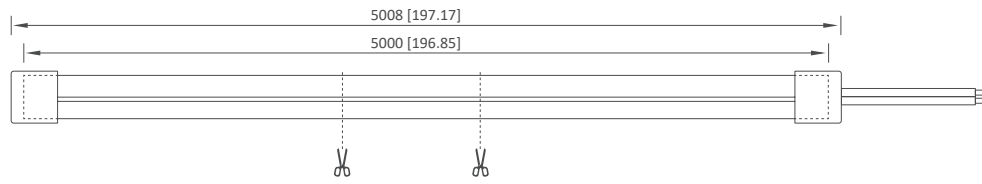

Front cap

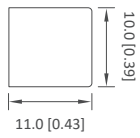

Closing End-cap

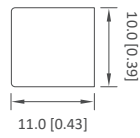

Remarks: "L" is the standard size of the light strip, can be customized according to the multiple of the minimum cutting unit length.

Sectional view

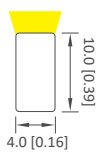

Bending Diameter

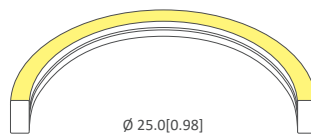

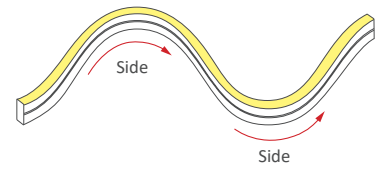

Top Bending



Product accessories

Free

	Front cap VNL-S4F-PCS	Quantity (m)/pcs: (5) 9 Dimensions (L*W*H)mm: 10*4.5*12
---	--------------------------	--

	Closing End-cap VNL-S4F-ECS	Quantity (m)/pcs: (5) 9 Dimensions (L*W*H)mm: 10*4.5*12
---	--------------------------------	--

Optional

	Silicone Glue VNL-SG45	Quantity (m)/pcs: (5) 1 300g/pc
---	---------------------------	------------------------------------



Features

- Color options: Single color, tunable white, RGB, RGBW and PIXEL.
- Design: Superior design with exquisite craftsmanship ensure stable and reliable performance.
- Flexibility: Side bending, min. bend diameter 60mm[2.36].
- IP grade: Silicone extrusion, molding pressed IP68 protection. Glue process end caps IP67 protection.
- Warranty: 5 years indoor, 3 years outdoor.
- Customization: multiple spec options, can be customized upon requirements

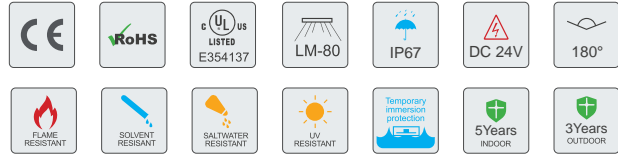

Photo-electric Parameters

Model No.	CRI	Voltage	Beam Angle	Color	Lm/m	Lm/W	Measured Power (W/m)
VNL-S10C-25k	>80	24V DC	180°	2500K	547	53	9.6±10%
VNL-S10C-41k				4100K	552	53	
VNL-S10C-50k				5000K	591	57	
VNL-S10C-65k				6500K	545	52	
VNL-S10C-R		24V DC	180°	Red	231	24	9.6±10%
VNL-S10C-G				Green	438	45	
VNL-S10C-B				Blue	91	9	
VNL-S10C-Y				Yellow	686	80	
VNL-S10C-TW	>80	24V DC	180°	2700K	297	41.4	7.2±10%
				6200K	280	39.4	7.2±10%
				W+N	565	39.5	14.4±10%
VNL-S10C-RGB	/	24V DC	179°	Red	50	10.3	5.76±10%
				Green	126	23.6	5.76±10%
				Blue	27	5.0	5.76±10%
				RGB	202	13.0	17.3±10%
VNL-S10C-RGBW	>80	24V DC	200°	6500K	91	17.3	5.2±10%
	/	24V DC		Red	26	6.2	4.2±10%
				Green	52	11.4	4.5±10%
				Blue	13	2.7	4.8±10%
				RGBW	173	9.4	18.4±10%
VNL-S10C-DIGITAL	/	24V DC	200°	Red	23	3.4	6.6±10%
				Green	47	6.9	6.9±10%
				Blue	11	1.5	6.9±10%
				RGB	77	5.5	14.0±10%
VNL-S10C-DIGITAL-RGBW	>80	24V DC	170°	2000-10000K	124	10.1	5.0±10%
	/	24V DC		Red	27	3.25	5.0±10%
				Green	64	5.4	5.0±10%
				Blue	17	1.4	5.0±10%
				RGBW	98	4.1	15.0±10%

Basic Parameters

Model No.	LED QTY (pcs/m)	Product Size L*W*H (mm)	Min. Cuttable Length (mm)	Working Temperature	Storage Temperature
VNL-S10C	120	15000*10*25	50	-20~+60°C	-20~+70°C
VNL-S10C-TW	240	10000*10*25	50		
VNL-S10C-RGBW	72	5000*10*25	83.3		
VNL-S10C-RGBW	72	5000*10*25	83.3		
VNL-S10C-DIGITAL	60	10000*10*25	100		
VNL-S10C-DIGITAL-RGBW	60	10000*10*25	100		

Profile Drawings

Unit:mm [inch]

Glue Process (IP67)

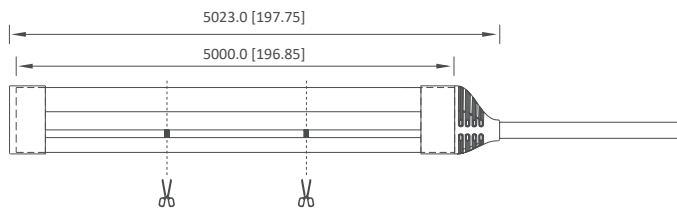

Molding Press Moulded (IP68)

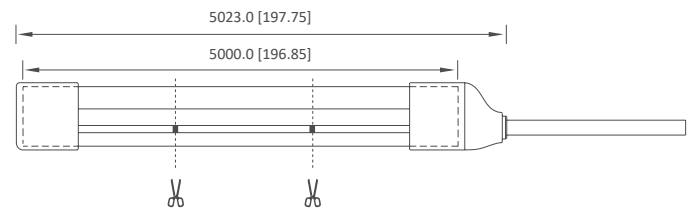

Sectional view

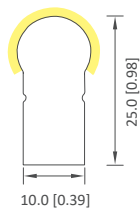

Bending Diameter

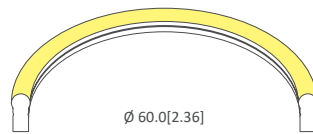

Top Bending

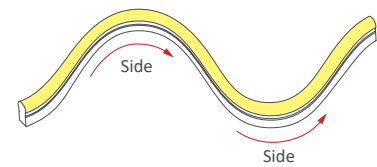

Front cap

Glue Process (IP67)

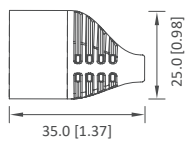

Molding pressed (IP68)

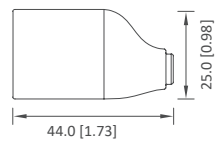

Closing End-cap

Glue Process (IP67)

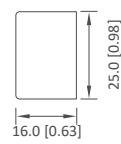

Molding pressed (IP68)

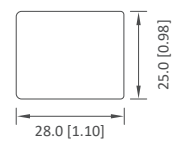

Remarks: "L" is the standard size of the light strip, can be customized according to the multiple of the minimum cutting unit length.

Product accessories

Free



Front cap
VNL-S10C-PCS

Quantity (m)/pcs: (5/10) 2-4
Dimensions (L*W*H)mm: 45*26*12



Closing End-cap
VNL-S10C-ECS

Quantity (m)/pcs: (5/10) 2-4
Dimensions (L*W*H)mm: 27*16*14

Optional



Front cap
(Molding pressed)
VNL-S10C-PCIIIM

Quantity (m)/pcs: (5/10) 2-4
Dimensions (L*W*H)mm: 44*28*15



White Sheathed Cable
VNL-S10C-PCAC

Quantity (m)/pcs: (5/10)
Dimensions (L*W*H)mm: 136



L Connector Set
VNL-S10C-ICL

Quantity (m)/pcs: (5/10)
Dimensions (L*W*H)mm: 30*32*32



S-type track
VNL-S10C-SP500

Quantity (m)/pcs: (5/10)
Dimensions (L*W*H)mm: 500*11*17



Aluminum Channel
VNL-S10C-AP1000/3000

Quantity (m)/pcs: (5/10): 1000*12.3*17



Silicone Glue
VNL-SG45

Quantity (m)/pcs: (5/10) 1
300g/pc



Closing End-cap
(Molding pressed)
VNL-S10C-ECIM

Quantity (m)/pcs: (5/10) 2-4
Dimensions (L*W*H)mm: 28*28*15



Connector Set
VNL-S10C-D-CCP

Quantity (m)/pcs: (5/10)
Dimensions (L*W*H)mm: 63.80*22.60*13.65



Connector Set
VNL-S10C-MCA

Quantity (m)/pcs: (5/10)
Dimensions (L*W*H)mm: 35*15*21



Aluminum track
VNL-S10C--AP35

Quantity (m)/pcs: (5/10)
Dimensions (L*W*H)mm: 25*12.3*17



Screws

Quantity (m)/pcs:
Dimensions: 10mm



Features

- Color options: Single color and tunable white.
- Design: Superior design with exquisite craftsmanship ensure stable and reliable performance.
- Flexibility: Side bending, min. bend diameter 30mm [1.18inch].
- IP grade: Silicone extrusion.Glue process end caps, IP67 protection.
- Warranty: 5 years indoor, 3 years outdoor.
- Customization: multiple spec options, can be customized upon requirements



Photo-electric Parameters

Model No.	CRI	Voltage	Color	Lm/m	Lm/W	Measured Power (W/m)
VNL-S6C-21K	>90	12V DC	2100K	66.3	5.8	11.52±10%
VNL-S6C-27K	>80	12V DC	2700K	159.0	14.6	11.52±10%
VNL-S6C-30K			3000K	126.4	11.5	10.9±10%
VNL-S6C-37K			3700K	166.7	14.9	11.52±10%
VNL-S6C-43K			4300K	162.4	14.4	11.52±10%
VNL-S6C-52K			5200K	158.1	14.1	11.52±10%
VNL-S6C-60K			6000K	167.5	15.3	10.9±10%
VNL-S6C-R	/	12V DC	Red	36	2.9	11.52±10%
VNL-S6C-G			Green	138	15	
VNL-S6C-B			Blue	39	3.6	
VNL-S6C-Y			Yellow	62	5.6	
VNL-S6C-O			Orange	86	7.5	
VNL-S6C-TW	>80	12V DC	2800K	190	29	14.4±10%
			5000K	200	31	

Basic Parameters

Model No.	LED QTY (pcs/m)	Product Size L*W*H (mm)	Min. Cuttable Length (mm)	Working Temperature	Storage Temperature
VNL-S6C	96	5000*6*15	10.42	-20~+60℃	-20~+70℃
VNL-S6C-TW	240	5000*6*15	25		

Profile Drawings

Unit:mm [inch]

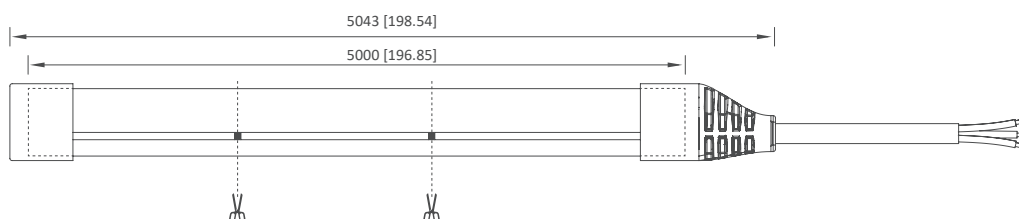

Front cap
Glue Process (IP67)

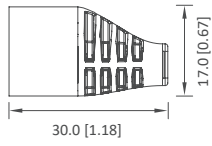

Closing End-cap
Glue Process (IP67)

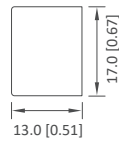

Remarks: "L" is the standard size of the light strip, can be customized according to the multiple of the minimum cutting unit length.

Sectional view

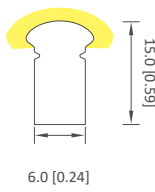

Bending Diameter

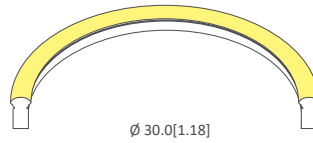

Top Bending

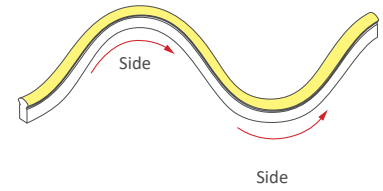

Luminous Intensity Distribution Diagram

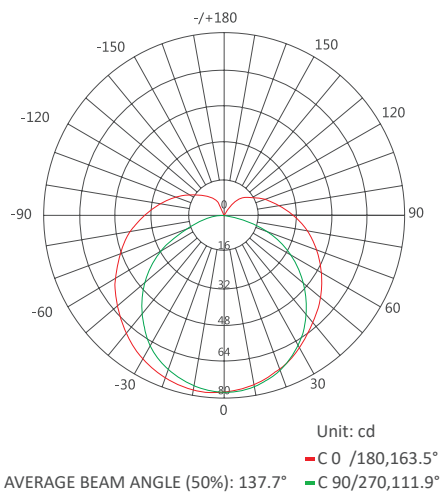

Note: the above two figures are tested with the sample VNL-S6C-TW.

Average Illumination

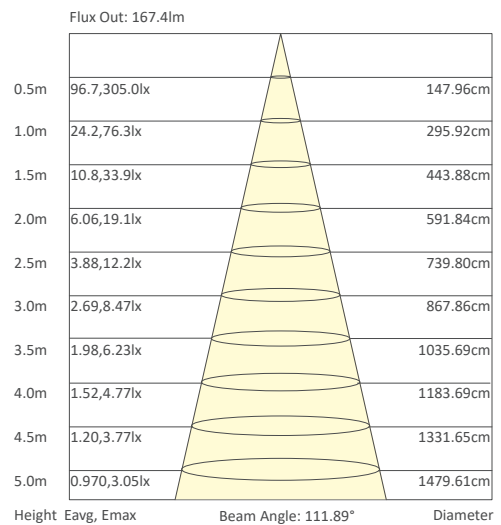

Product accessories

Free



Front cap
VNL-S6C-PCS

Quantity (m)/pcs: (5) 3
Dimensions (L*W*H)mm: 30*9.57*16.4



Closing End-cap
VNL-S6C-ECS

Quantity (m)/pcs: (5) 3
Dimensions (L*W*H)mm: 14*10*16

Optional



Plastic Clip
VNL-S6C-MCP

Quantity (m)/pcs: (5)
Dimensions (L*W*H)mm: 12*9*10



Screws

Quantity (m)/pcs:
Dimensions: 10mm



Silicone Glue
VNL-SG45

Quantity (m)/pcs: (5) 1
300g/pc



Features

- Color options: Single color temperature.
- Design: Superior design with exquisite craftsmanship ensure stable and reliable performance.
- Flexibility: Top bending, min. bend diameter 30mm[1.18inch].
- IP grade: Silicone extrusion.Glue process end caps, IP67 protection.
- Warranty: 5 years indoor, 3 years outdoor.
- Customization: multiple spec options, can be customized upon requirements



Photo-electric Parameters

Model No.	CRI	Voltage	Color	Lm/m	Lm/W	Measured Power (W/m)
VNL-S5C-23K	>90	24V DC	2300K	215	22.1	9.6±10%
VNL-S5C-25K	>80	24V DC	2500K	194	18.7	9.6±10%
VNL-S5C-27K			2700K	183	19.2	9.6±10%
VNL-S5C-29K			2900K	189	19.0	9.6±10%
VNL-S5C-40K			4000K	211	20.4	9.6±10%
VNL-S5C-50K			5000K	205	19.8	9.6±10%
VNL-S5C-60K			6000K	221	20.2	10.9±10%

Basic Parameters

Model No.	LED QTY (pcs/m)	Product Size L*W*H (mm)	Min. Cuttable Length (mm)	Working Temperature	Storage Temperature
VNL-S5C	120	5000*5*12	50	-20~+60°C	-20~+70°C

Luminous Intensity Distribution Diagram

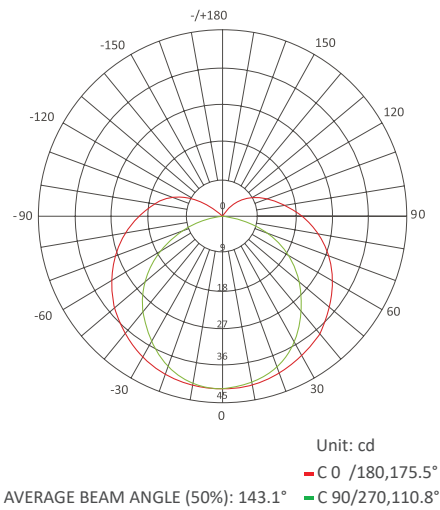

Average Illumination

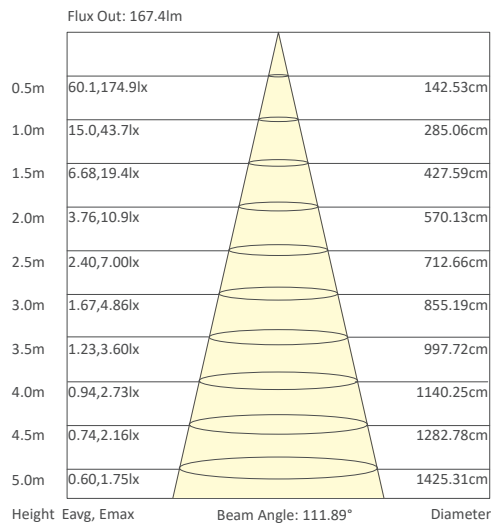

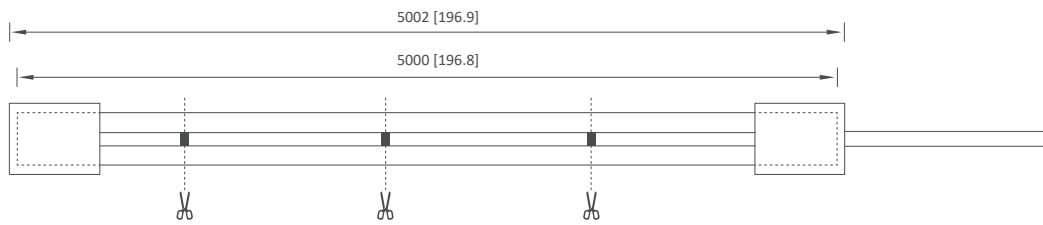

Front cap
Glue Process (IP67)

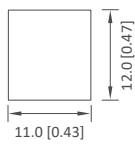

Closing End-cap
Glue Process (IP67)

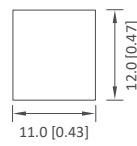

Remarks: "L" is the standard size of the light strip, can be customized according to the multiple of the minimum cutting unit length.

Sectional view

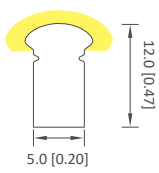

Bending Diameter

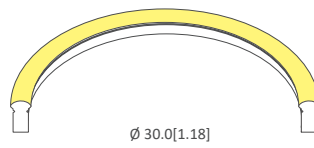

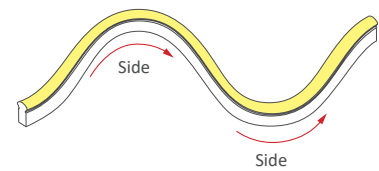

Top Bending



Product accessories

Free

	Front cap VNL-SSC-PCS	Quantity (m)/pcs: (5) 3 Dimensions (L*W*H)mm: 11*14*8
---	--------------------------	--

	Closing End-cap VNL-SSC-ECS	Quantity (m)/pcs: (5) 3 Dimensions (L*W*H)mm: 11*14*8
---	--------------------------------	--

Optional

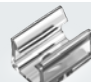
	Plastic Clip VNL-SSC-MCP	Quantity (m)/pcs: (5) Dimensions (L*W*H)mm: 12*9*10
---	-----------------------------	--

	Screws	Quantity (m)/pcs: Dimensions: 10mm
---	--------	---------------------------------------

	Silicone Glue VNL-SG45	Quantity (m)/pcs: (5) 1 300g/pc
---	---------------------------	------------------------------------



Features

- Color options: Tunable white, RGBY.
- Design: Superior design with exquisite craftsmanship ensure stable and reliable performance.
- Flexibility: Side bending, min. bend diameter 30mm[1.18].
- IP grade: Silicone extrusion, molding pressed IP68 protection. Glue process end caps IP67 protection.
- Warranty: 5 years indoor, 3 years outdoor.
- Customization: multiple spec options, can be customized upon requirements

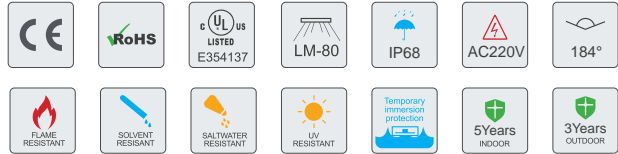

Photo-electric Parameters

Model No.	CRI	Voltage	Color	Lm/m	Lm/W	Measured Power (W/m)
VNL-S10C-AC	>80	220V AC	2800-9000K	510	51	10.0±10%
VNL-S10C-R-AC	/	220V AC	Red	230	/	10.0±10%
VNL-S10C-G-AC			Green	420	/	
VNL-S10C-B-AC			Blue	90	/	
VNL-S10C-Y-AC			Yellow	650	/	

Basic Parameters

Model No.	LED QTY (pcs/m)	Product Size L*W*H (mm)	Min. Cuttable Length (mm)	Storage Temperature	Working Temperature
VNL-S10C-AC	120	50000*10*25	500	-20~+60°C	-20~+70°C

Luminous Intensity Distribution Diagram

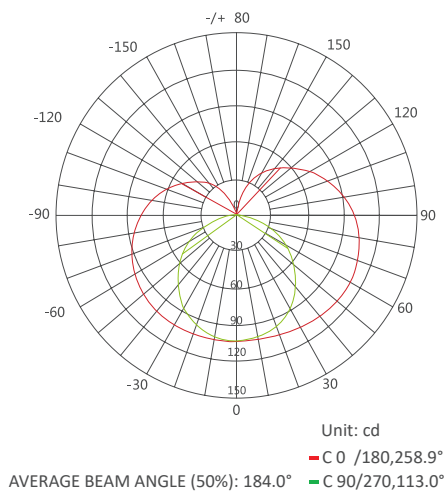

Average Illumination

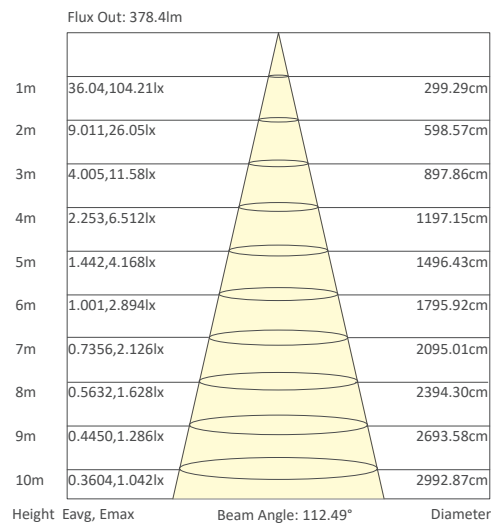

Profile Drawings

Unit:mm [inch]

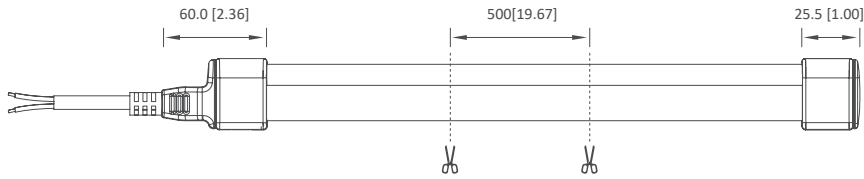

Sectional view

Bending Diameter

Top Bending

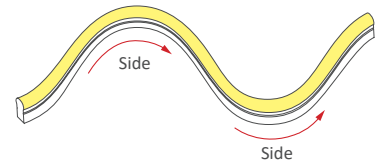
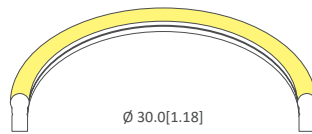
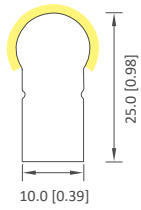

Front cap

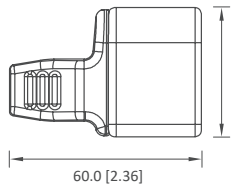

Closing End-cap

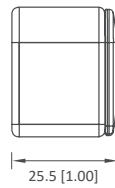











Remarks: "L" is the standard size of the light strip, can be customized according to the multiple of the minimum cutting unit length.

Product accessories

Free

	Front cap VNL-S10C-AC-PCS	Quantity (m)/pcs: (5/10) 2-4 Dimensions (L*W*H)mm: 45*26*12		Closing End-cap VNL-S10C-AC-ECS	Quantity (m)/pcs: (5/10) 2-4 Dimensions (L*W*H)mm: 27*16*14
---	------------------------------	--	---	------------------------------------	--

Optional

	Front cap (Molding pressed) VNL-S10C-AC-PCIIM	Quantity (m)/pcs: (5/10) 2-4 Dimensions (L*W*H)mm: 44*28*15		Closing End-cap (Molding pressed) VNL-S10C-AC-ECIM	Quantity (m)/pcs: (5/10) 2-4 Dimensions (L*W*H)mm: 28*28*15
	White Sheathed Cable VNL-S10C-PCAC	Quantity (m)/pcs: (5/10) Dimensions (L*W*H)mm: 136		Connector Set VNL-S10C-AC-CCP	Quantity (m)/pcs: (5/10) Dimensions (L*W*H)mm: 63.80*22.60*13.65
	S-type track VNL-S10C-AC-SP500	Quantity (m)/pcs: (5/10) Dimensions (L*W*H)mm: 500*13.5*13.6		Connector Set VNL-S10C-AC-MCA	Quantity (m)/pcs: (5/10) Dimensions (L*W*H)mm: 35*15*21
	Aluminum channel VNL-S10C-AP1000/3000	Quantity (m)/pcs: (5/10): 1000*18.7*19.		Aluminum track VNL-S10C-AC-AP35	Quantity (m)/pcs: (5/10) Dimensions (L*W*H)mm: 35*21.2*19
	Silicone Glue VNL-SG45	Quantity (m)/pcs: (5/10) 1 300g/pc		Screws	Quantity (m)/pcs: Dimensions: 10mm

360° ROUND
BENDING
NEON FLEX

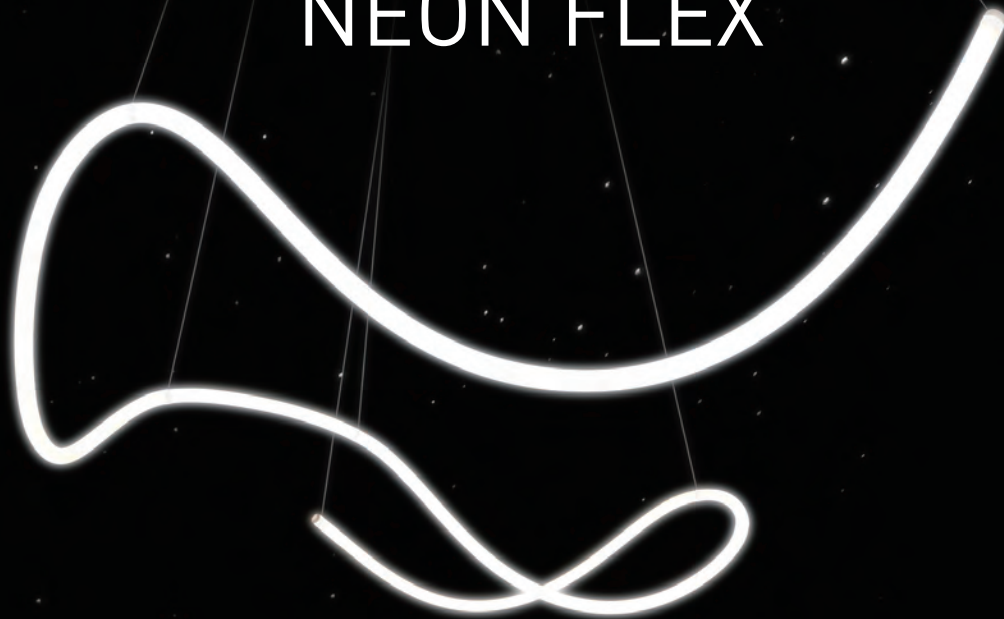





Features

- Color options: Single color.
- Design: Superior design with exquisite craftsmanship ensure stable and reliable performance.
- Flexibility: 360 lighting, min. bend diameter 120mm [4.72inch].
- IP grade: Silicone extrusion, IP65 protection.
- Warranty: 5 years indoor, 3 years outdoor.
- Customization: multiple spec options, can be customized upon requirements.



Photo-electric Parameters

Model No.	CRI	Voltage	Color	Lm/m	Lm/W	Measured Power (W/m)
VNL-R23C-24K	>80	24V DC	2400K	1156	71.6	16.0±10%
VNL-R23C-27K			2700K	1270	84.3	
VNL-R23C-30K			3000K	1457	90.3	
VNL-R23C-40K			4000K	1466	90.5	
VNL-R23C-50K			5000K	1473	92.8	
VNL-R23C-65K			6500K	1362	85.1	
VNL-R23C-R	24V DC	Red	435	27.2	16.0±10%	
VNL-R23C-G		Green	1338	83.6		
VNL-R23C-B		Blue	315	19.7		
VNL-R23C-Y		Yellow	201	12.6		
VNL-R23C-O		Orange	393	24.6		
VNL-R23C-RGB	24V DC	Red	108	17.8	6.4±10%	
		Green	498	67.0		6.4±10%
		Blue	103	15.6		6.4±10%
		RGB	696	35.4		19.2±10%

Basic Parameters

Model No.	LED QTY (pcs/m)	Product Size L*W*H (mm)	Working Temperature	Storage Temperature
VNL-R23C	336	5000*23*23	-20~+60°C	-20~+70°C
VNL-R23C-RGB	288			

Profile Drawings

Unit:mm [inch]

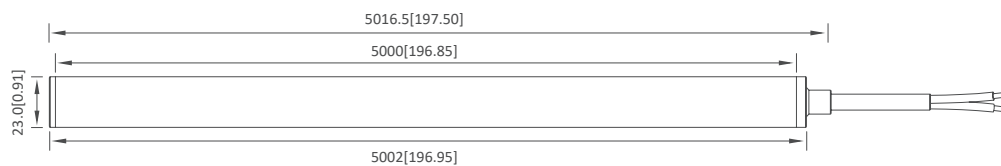

Sectional view

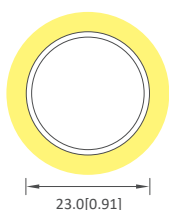

Bending Diameter

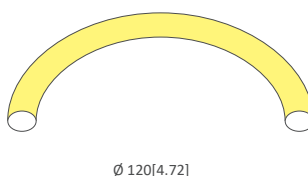

Top Bending

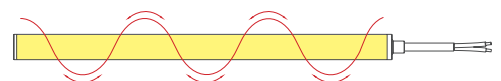

Front cap

Glue Process (IP67)

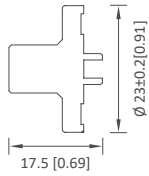

Closing End-cap

Glue Process (IP67)

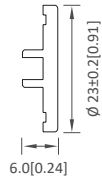

Remarks: "L" is the standard size of the light strip, can be customized according to the multiple of the minimum cutting unit length.

Luminous Intensity Distribution Diagram

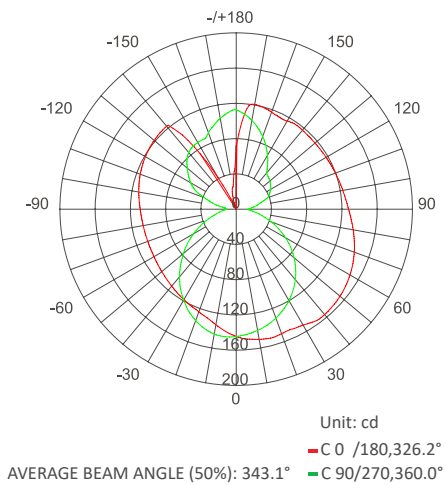

Note: The above datas are tested with the sample 6500K.

Average Illumination

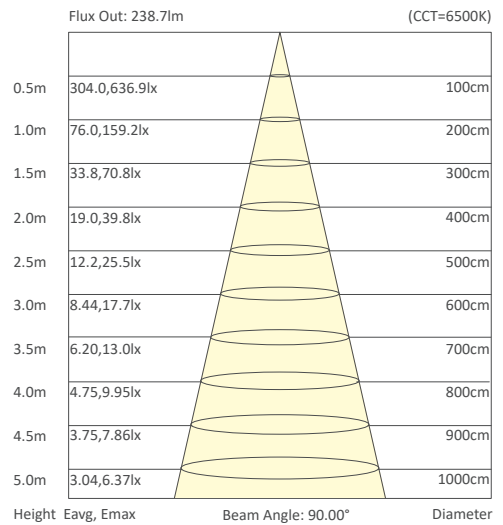

Installation method

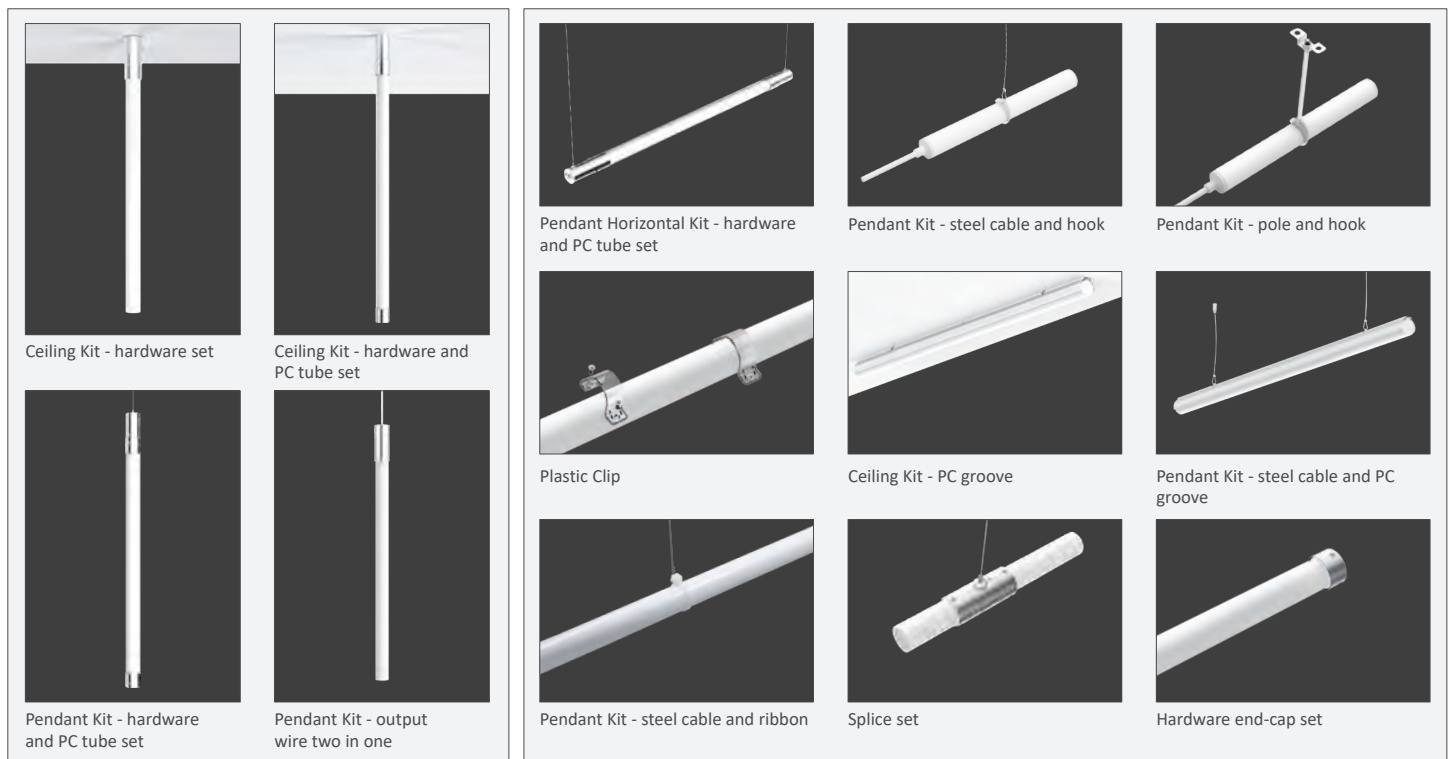

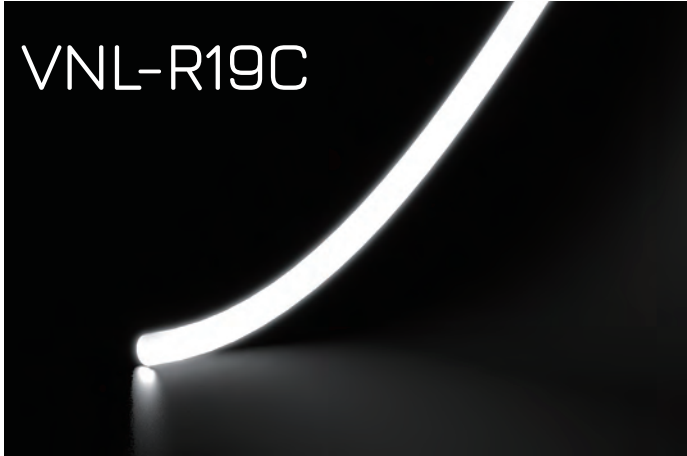

Features

- Color options: Single color and RGB.
- Design: Superior design with exquisite craftsmanship ensure stable and reliable performance.
- Flexibility: 360 lighting, min. bend diameter 120mm [4.72inch].
- IP grade: Silicone extrusion, IP65 protection.
- Warranty: 5 years indoor, 3 years outdoor.
- Customization: multiple spec options, can be customized upon requirements.



Photo-electric Parmamters

Model No.	CRI	Voltage	Color	Lm/m	Lm/W	Measured Power (W/m)
VNL-R19C-24K	>80	24V DC	2400K	1029	63.6	16.0±10%
VNL-R19C-27K			2700K	1198	75.7	
VNL-R19C-30K			3000K	1267	78.6	
VNL-R19C-40K			4000K	1348	84.1	
VNL-R19C-50K			5000K	1301	79.8	
VNL-R19C-65K			6500K	1207	74.8	
VNL-R19C-R	/	24V DC	Red	387	24.2	16.0±10%
VNL-R19C-G			Green	960	60.0	
VNL-R19C-B			Blue	241	15.1	
VNL-R19C-Y			Yellow	143	8.9	
VNL-R19C-O			Orange	322	20.1	
VNL-R19C-RGB			/	24V DC	Red	
	Green	369			58.5	6.2
	Blue	73			11.9	6.1
	RGB	544			29.5	18.4

Basic Parameters

Model No.	LED QTY (pcs/m)	Product Size L*W*H (mm)	Working Temperature	Storage Temperature
VNL-R19C	336	5000*19*19	-20~+60℃	-20~+70℃
VNL-R19C-RGB	288			

Profile Drawings

Unit:mm [inch]

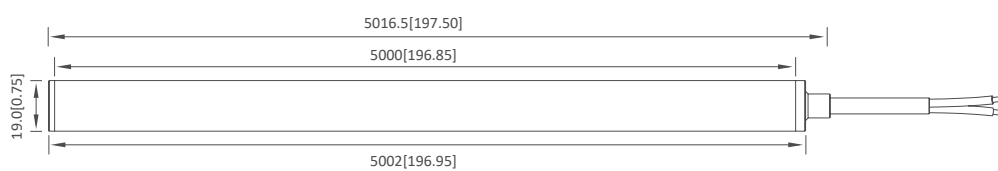

Sectional view

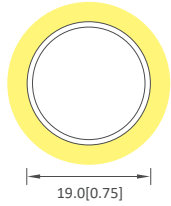

Bending Diameter

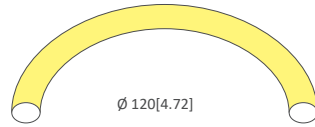

Top Bending

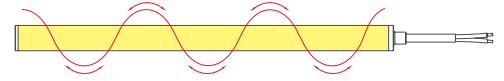

Front cap

Glue Process (IP67)

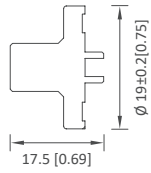

Closing End-cap

Glue Process (IP67)

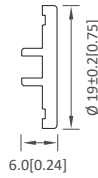

Remarks: "L" is the standard size of the light strip, can be customized according to the multiple of the minimum cutting unit length.

Luminous Intensity Distribution Diagram

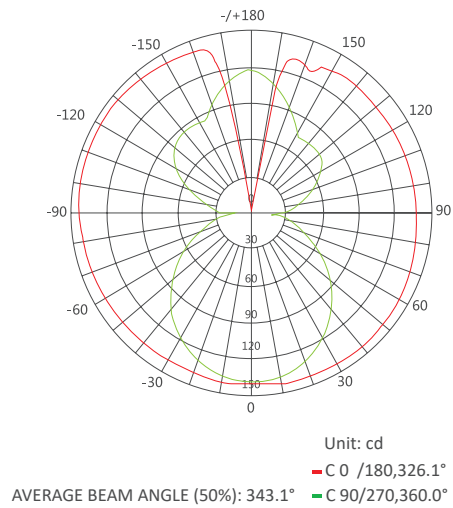

Note: The above datas are tested with the sample 6500K.

Average Illumination

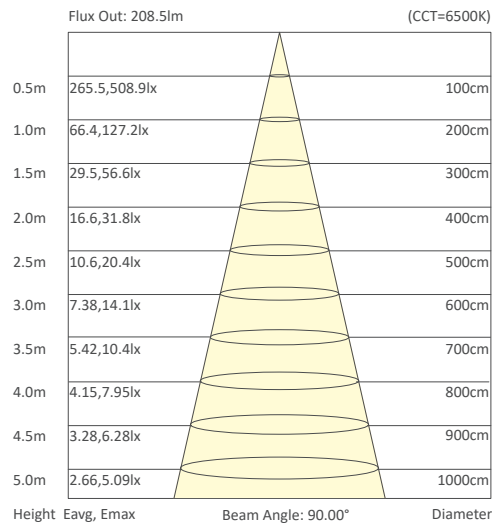

Installation method

Pendant Pole and hook set

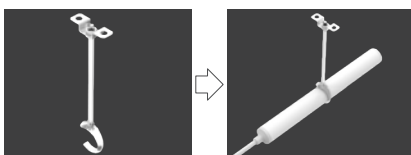

Pendant Rope and hook set

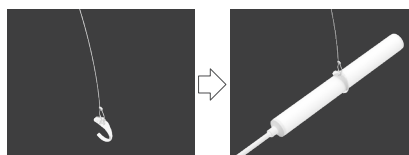

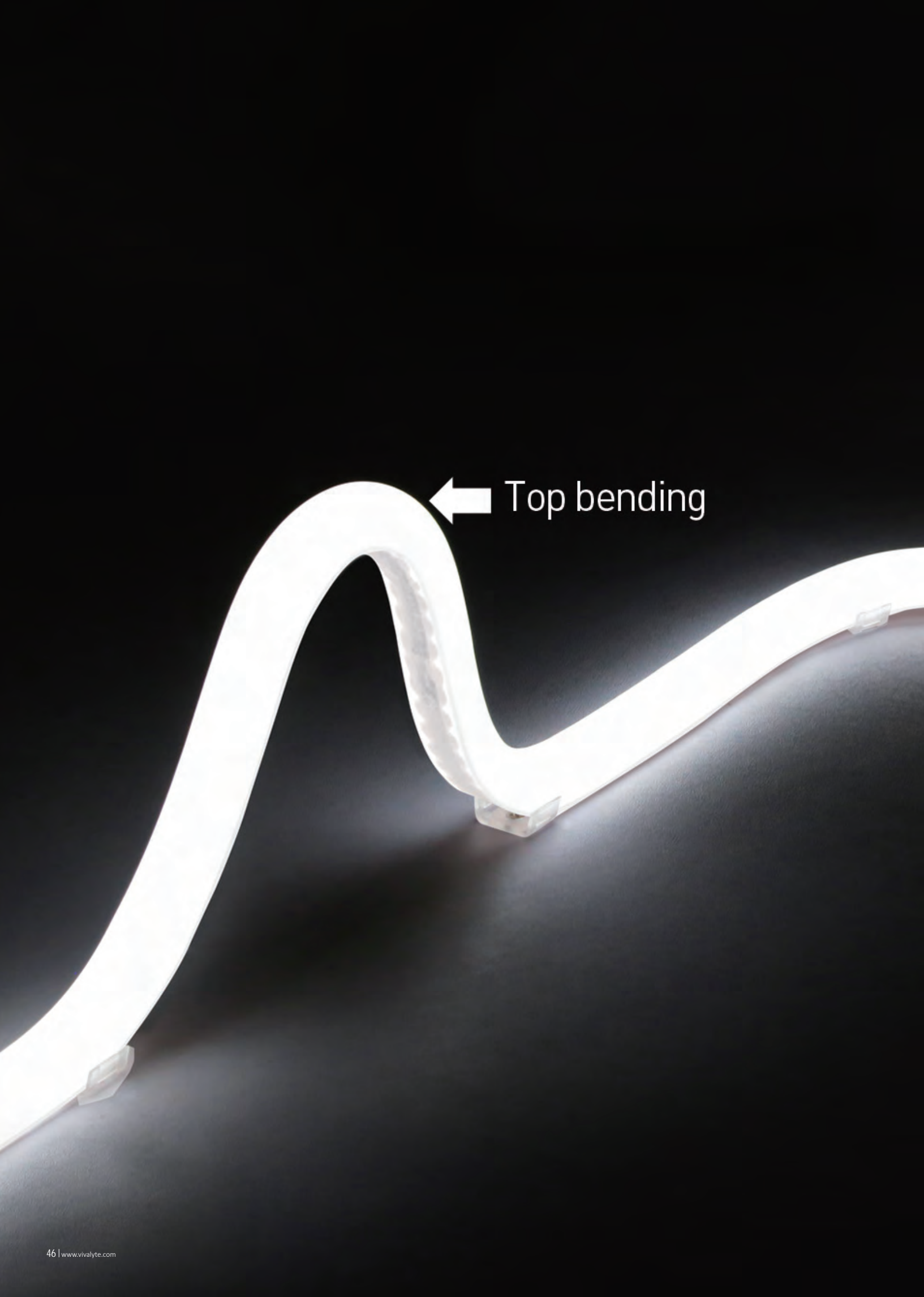

← Top bending



Side bending

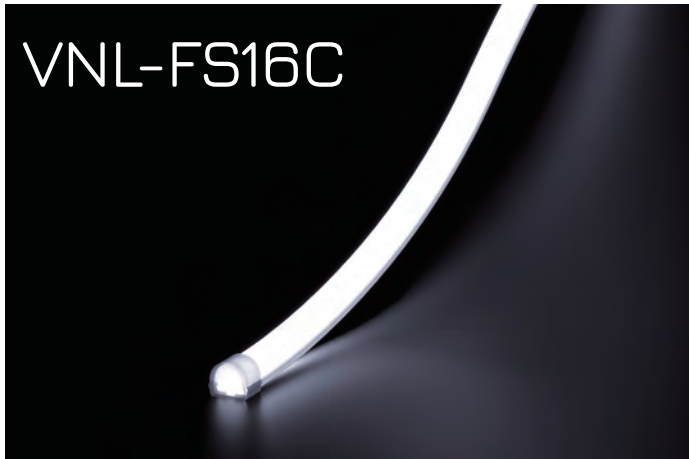

Features

- Color options: Single color.
- Design: Superior design with exquisite craftsmanship ensure stable and reliable performance.
- Flexibility: Top bending, min. bend diameter 60mm [2.36inch]. Side bending, min. bend diameter 150mm [5.91inch]
- IP grade: Silicone extrusion, glue process end caps, IP67 protection.
- Warranty: 5 years indoor, 3 years outdoor.
- Customization: multiple spec options, can be customized upon requirements.



Photo-electric Parameters

Model No.	CRI	Voltage	Color	Lm/m	Lm/W	Measured Power (W/m)
VNL-FS16C-22K	>90	24V DC	2200K	508	66	7.2±10%
VNL-FS16C-28K			2800K	540	70	
VNL-FS16C-32K			3200K	560	74	
VNL-FS16C-39K			3900K	560	74	
VNL-FS16C-55K			5500K	570	74	

Basic Parameters

Model No.	LED QTY (pcs/m)	Product Size L*W*H (mm)	Min. Cuttable Length (mm)	Working Temperature	Storage Temperature
VNL-FS16C	120	5000*16.5*15.2	50.0	-20~+60°C	-20~+70°C

Luminous Intensity Distribution Diagram

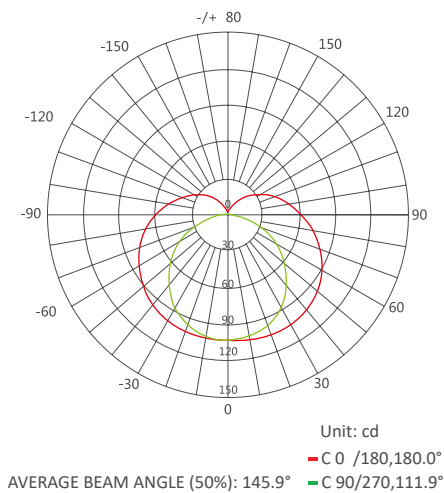

Average Illumination

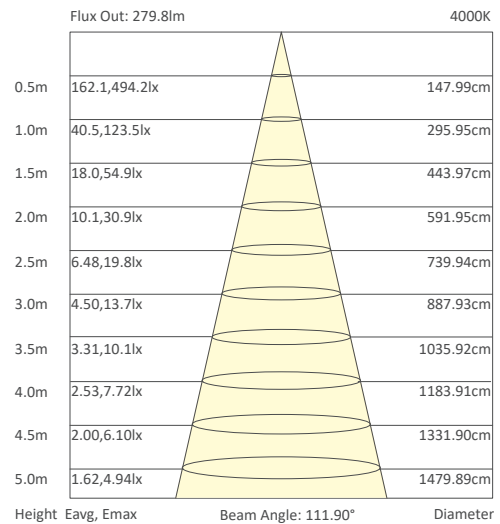

Note: The above datas are tested with the sample 4000K.

Profile Drawings

Unit:mm [inch]

Glue Process (IP67)

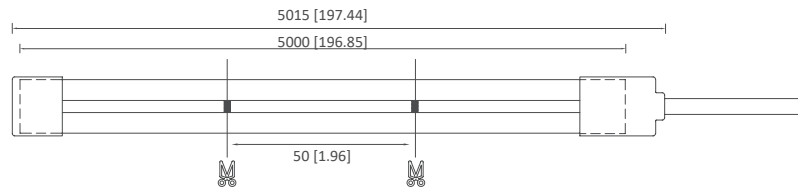

Sectional view

Bending Diameter

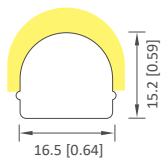

Top Bending

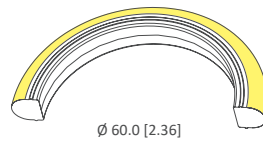

Side Bending

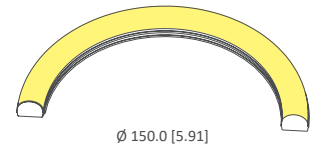

Front cap

Closing End-cap

Bend direction

Glue Process (IP67)

Glue Process (IP67)

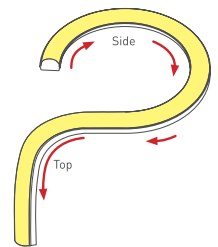
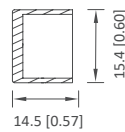
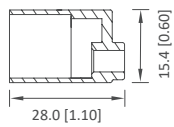

Remarks: "L" is the standard size of the light strip, can be customized according to the multiple of the minimum cutting unit length.

Product accessories

Free

	Front cap VNL-FS16C-PCS	Quantity (m)/pcs: (10) 6 Dimensions (L*W*H)mm: 28*20.1*17.6		Closing End-cap VNL-FS16C-ECS	Quantity (m)/pcs: (10) 6 Dimensions (L*W*H)mm: 14.5*20.1*17.6
---	----------------------------	--	---	----------------------------------	--

Optional

	Front cap (Left) VNL-FS16C-PCL	Quantity (m)/pcs: (10) 6 Dimensions (L*W*H)mm: 27*24.9*17.6		Front cap (Right) VNL-FS16C-PCR	Quantity (m)/pcs: (10) 6 Dimensions (L*W*H)mm: 27*25.2*17.6
	Front cap (Bottom) VNL-FS16C-PCB	Quantity (m)/pcs: (10) 6 Dimensions (L*W*H)mm: 27*19.5*23.6		Aluminum Track VNL-FS16C-AP35	Quantity (m)/pcs: (10) 30 Dimensions (L*W*H)mm: 35*19.2*9.4
	Aluminum Channel VNL-FS16C-AP1000	Quantity (m)/pcs: (10) 10 Dimensions (L*W*H)mm: 1000*19.2*9.4		Screws	NMR1615-AMC: 2pcs/piece NMR1615-AC: 3pcs/piece Dimensions: 10mm
	Silicone Glue VNL-SG45	Quantity (m)/pcs: (5/10) 1 300g/pc			



SKIN COLOR NEON SERIES

Features

- Excellent shading and light transmission
- Attractive design, multiple colors optional
- Extrusion modeling with excellent weather resistance
- Multiple size optional, cuttable and customizable

Application

- Applied for advertising neon channel letters etc.

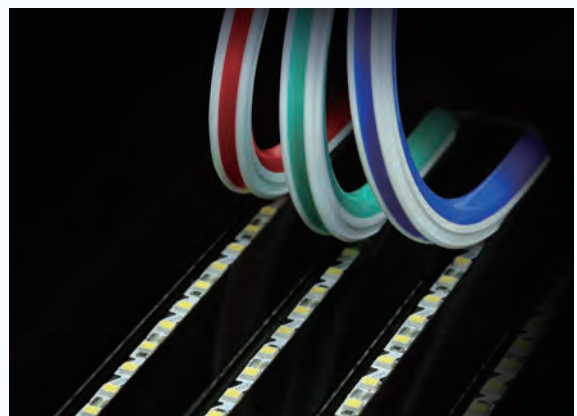

ROLLABLE SILICONE NEON COVER

CRXXXX

Photo-electric Parmamters

Model No.	Voltage	CRI	LED + Cover	Color	CCT/Wavelength	Lm/m	Lm/W	Measured Power (W/m)
VNL-SC8C-WW	12V DC	>80	WW	W	6107K	291	78	7.2±10%
VNL-SC8C-WR			WR	R	620-625nm	18	5	
VNL-SC8C-WG			WG	G	520-525nm	19	5	
VNL-SC8C-WB			WB	B	465-470nm	20	5	
VNL-SC8C-WY			WY	Y	587-589.5nm	62	17	
VNL-SC8C-WO			WO	O	600-605nm	75	20	
VNL-SC8C-BW			BW	B	465-470nm	55	14	
VNL-SC8C-GW			GW	G	520-525nm	180	44	
VNL-SC8C-RW			RW	R	620-625nm	69	20	
VNL-SC8C-OW			OW	O	600-605nm	78	23	
VNL-SC8C-YW			YW	Y	587-589.5nm	43	13	
VNL-SC8C-BB			BB	B	465-470nm	8	2	
VNL-SC8C-GG			GG	G	520-525nm	28	7	
VNL-SC8C-RR			RR	R	620-625nm	28	8	
VNL-SC8C-OO			OO	O	600-605nm	38	11	
VNL-SC8C-YY			YY	Y	587-589.5nm	14	4	

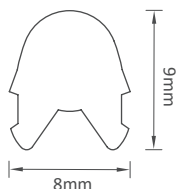

Model No.	Voltage	CRI	LED + Cover	Color	CCT/Wavelength	Lm/m	Lm/W	Measured Power (W/m)
VNL-SC10C-WW	12V DC	>80	WW	W	6107K	248	66	7.2±10%
VNL-SC10C-WR			WR	R	620-625nm	9	2	
VNL-SC10C-WG			WG	G	520-525nm	48	13	
VNL-SC10C-WB			WB	B	465-470nm	16	4	
VNL-SC10C-WY			WY	Y	587-589.5nm	2	1	
VNL-SC10C-WO			WO	O	600-605nm	56	15	
VNL-SC10C-BW			BW	B	465-470nm	61	18	
VNL-SC10C-GW			GW	G	520-525nm	37	11	
VNL-SC10C-RW			RW	R	620-625nm	155	38	
VNL-SC10C-OW			OW	O	600-605nm	49	13	
VNL-SC10C-YW			YW	Y	587-589.5nm	58	17	
VNL-SC10C-BB			BB	B	465-470nm	20	6	
VNL-SC10C-GG			GG	G	520-525nm	10	3	
VNL-SC10C-RR			RR	R	620-625nm	22	5	
VNL-SC10C-OO			OO	O	600-605nm	4	1	
VNL-SC10C-YY			YY	Y	587-589.5nm	27	8	

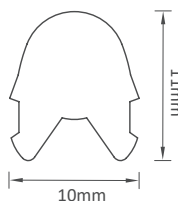

Model No.	Voltage	CRI	LED + Cover	Color	CCT/Wavelength	Lm/m	Lm/W	Measured Power (W/m)
VNL-SC12C-WW	12V DC	>80	WW	W	6107	270	72	7.2±10%
VNL-SC12C-WR			WR	R	620-625nm	7	2	
VNL-SC12C-WG			WG	G	520-525nm	43	11	
VNL-SC12C-WB			WB	B	465-470nm	11	3	
VNL-SC12C-WY			WY	Y	587-589.5nm	3	1	
VNL-SC12C-WO			WO	O	600-605nm	49	13	
VNL-SC12C-BW			BW	B	465-470nm	68	20	
VNL-SC12C-GW			GW	G	520-525nm	35	10	
VNL-SC12C-RW			RW	R	620-625nm	160	13	
VNL-SC12C-OW			OW	O	600-605nm	50	13	
VNL-SC12C-YW			YW	Y	587-589.5nm	66	19	
VNL-SC12C-BB			BB	B	465-470nm	18	5	
VNL-SC12C-GG			GG	G	520-525nm	9	3	
VNL-SC12C-RR			RR	R	620-625nm	20	5	
VNL-SC12C-OO			OO	O	600-605nm	3	1	
VNL-SC12C-YY			YY	Y	587-589.5nm	28	8	

